

File: 590

APP. 64

Title: Utilites. Requests for Material, Repair, etc.

Origin: Cebanatuan POW Camp

Dates: 1944

Classification: None

Both sides

Authenticity: Originals and Carbon copies, some signed.

Source: Unknown

Extracted by *W. H. ...*

Date *Jan 26*

Microfilmed

Date _____

SCREENED

DECLASSIFIED
Authority *ND883018*

X X X X X X X X X X X X X X X

ARCHIVES FILE NUMBER 590 --- ---

TITLE UTILITIES, REQUESTS FOR MATERIAL, REPAIR ETC. ---

ORIGIN CABANATUAN POW CAMP ---

DATES 1944 ---

AUTHENTICITY ORIGINALS AND CARBON COPIES, SOME SIGNED ---

SOURCE UNKNOWN ---

X X X X X X X X X X X X X X X

DECLASSIFIED
Authority NND88308

MILITARY PRISON CAMP NUMBER I OF THE PHILIPPINE ISLANDS
Cabanatuan, P. I.

30 March, 1944.

SUBJECT: Installation of electric lights in kitchens.

To: The Commanding Officer, Military Prison Camp No. I
of the Philippine Islands, Cabanatuan, P. I.

1. It is requested that electric lights be installed
in the Camp kitchens.

2. At present, the cooks and food handlers, working
in the dark in the evening or early morning hours, are under
handicap and in danger of being seriously burned from the
kawas of boiling water or rice.

Respectfully,

CURTIS T. BEECHER,
Lt-Colonel, US. Marine Corps,
Commanding.

*lights
installed*

420

DECLASSIFIED
Authority *NVD883078*

February 25, 1944

SUBJECT : Remodeling of Latrine Shelter.

TO : Commanding Officer, Philippine
Military Prison Camp No. 1,
Cabanatuan, P. I.

1. It is respectfully requested that permission be granted to remodel the latrine shelter in rear of Group Utilities, in order to make two latrine shelters, using one in the present location and one on the new latrine just south of the location of the latrine shelter in question.

2. No new materials are required.

LEO C. PAQUET,
Lt. Colonel, Inf.,
Group Commander.

1st Ind.

American Prison Headquarters, Military Prison Camp
No. 1 of the Philippine Islands, Cabanatuan, P. I.,
February 26, 1944. To: Commanding Officer, Military
Prison Camp No. 1 of the Philippine Islands.

Forwarded recommending approval.

Respectfully,

CURTIS T. BEECHER,
Lieutenant-Colonel, U. S. Marine Corps,
Commanding.

*Approved 2/28/44
Thayer Cross advised*

DECLASSIFIED
Authority *ND88308*

3 at top

MILITARY PRISON CAMP NO. 1 OF THE PHILIPPINE ISLANDS
CABANATUAN, P. I.

29 February 1944

SUBJECT: Construction of Urinal

TO: Commanding Officer, Military Prison Camp No. 1 of
the Philippine Islands, Cabanatuan, P. I.

1. It is requested that permission be granted to construct a covered urinal immediately to the southeast of building No. 7, Hospital Area.

2. If approved, construction of this urinal can be completed today.

3. No material will be required to do this construction work.

Respectfully,

CURTIS T. BEECHER
Lieutenant-Colonel, U. S. Marine Corps
Commanding.

Approved 2/29/44

494
1944

DECLASSIFIED
Authority *ND88308*

HEADQUARTERS GROUP I

February 29, 1944.

SUBJECT : Digging of sump.

TO : Commanding Officer, Philippine
Military Prison Camp No. I,
Cabanatuan, P. I.

Respectfully request permission to dig
a new refuse sump along the rear drainage
ditch (west side) and that permission also
be granted to fill in the old sump located
in the same area.

LEO C. PAQUET,
Lt. Colonel, Inf.,
Group Commander.

1st Ind.

American Prisoner Headquarters, Military
Prison Camp No. 1 of the Philippine Islands,
Cabanatuan, P. I., February 29, 1944. To:
Commanding Officer, Military Prison Camp
No. 1 of the Philippine Islands, Cabanatuan,
P. I.

Forwarded, recommending approval.

CURTIS T. BEECHER
Lieutenant-Colonel, U. S. Marine Corps
Commanding.

Approved 3/1/44

*Old sump must not be
"re-used" on filling*

5 9/1000

DECLASSIFIED
Authority *NND88308*

SUBJECT: Electric Light for Chapel, Group II.

TO: Japanese Military Administration, through Channels.

1. Catholic services in Group II commence at 5:00 A.M. and continue each half hour until men leave for work. The daily program also includes evening devotions at 7:15 P.M. These services are held in the Group Chapel. It is requested that an electric light be installed for these services.

2. Often scheduled services are not conducted because the assembly is left in darkness. Candles do not serve here, as in an enclosed place, but, due to draft and wind, flicker and burn down, and often blow out. But at this time, due to the solicitude of the authorities as to the conduct of religious programs in this camp we make this request. The Chapel in Group II is conveniently situated for an extension of line, from the Southwest corner of the camp.

3. The use of an electric light in the Chapel is, after all, a facility to the men, and, it is in their name especially that the request is made. Over a hundred men daily assemble at the Chapel before and at the end of their labor in the fields.

Respectfully,

JOHN L. CURRAN,
Catholic Chaplain,
Group II.

DECLASSIFIED
Authority NND88308

No answer

6 9/10

GROUP II

18 February, 1944.

FIRST ENDORSEMENT

TO: Japanese Military Administration, through Channels.

1. An electric light is greatly needed for both Catholic and Protestant services which must be held during hours of darkness.

2. The light if installed in the Chapel would only be used for scheduled Religious Services.

RALPH W. D. BROWN,
Chaplain, Major, U.S. Army,
Group II Chaplain.

GROUP II

18 February, 1944.

SECOND ENDORSEMENT

TO: Japanese Military Administration, through Channels.

1. Forwarded, recommending approval.

J.G. COOK,
Lieutenant-Colonel, F.A., U.S.A.,
Commanding Group II.

3rd Ind.

American Prisoner Headquarters, Military Prison Camp No. 1
of the Philippine Islands, Cabanatuan, P.I., 19 February 1944.

To: Commanding Officer, Military Prison Camp No. 1 of the
Philippine Islands, Cabanatuan, P. I.

DECLASSIFIED
Authority: NND 883078

Philippine Headquarters,
February 17, 1944.

The Commanding Officer, Imperial Japanese Army, Military Prison
of the Philippine Islands, Cabanatuan, P. I.

Philippine Islands, Cabanatuan, P. I.

Hospital Headquarters,
February 17, 1944.

SUBJECT: Construction of Sump.

TO : The Commanding Officer, Imperial Japanese Army, Military Prison Camp
No. 1 of the Philippine Islands, Cabanatuan, P. I.

1. Respectfully request permission to dig a sump in the Hospital Area
west of the Guard Path and south of Building #13, location being indicated in
the attached sketch.

For the Chief of Hospital:

C. S. MAUPIN,
Major, Medical Corps,
Adjutant.

DECLASSIFIED
Authority NND883018

7
afp

MILITARY PRISON CAMP NO. 1 OF THE PHILIPPINE ISLANDS,
Cabanatuan, P. I.

CSM/g

Hospital Headquarters,
February 16, 1944.

SUBJECT: Construction of Sump.

TO : The Commanding Officer, Imperial Japanese Army, Military Prison Camp
No. 1 of the Philippine Islands, Cabanatuan, P. I.

1. Respectfully request permission to dig a sump in the Hospital Area in
the vicinity of Mess #1, location being indicated in the attached sketch.

For the Chief of Hospital:

DECLASSIFIED

Authority NND883018

C. S. Maupin
C. S. MAUPIN,
Major, Medical Corps,
Adjutant.

A- LATRINES

- 1- FLUSH LATRINES 3 TIMES DAILY
- 2- WASH BOXES DAILY
- 3- POLICE LATRINE AREA

B- BEAUTIFICATION

- 1- COMPLETE LEVELING OF AREA OUTSIDE OF GUARD PATH.
- 2- CUT GRASS IN AREA
- 3- REPAIR BRIDGES
- 4- LEVEL AREA NORTH OF MESS #1
- 5- LEVEL AREA AROUND MORGUE
- 6- IMPROVE GUARD PATH
- 7- CLEAN & GRADE MAIN DRAINAGE DITCHES
- 8- FILL & LEVEL AREA AROUND DELOUSES
- 9- LEVEL AREA EAST OF SURGERY
- 10- LEVEL AREA WEST OF HEADQUARTERS
- 11- INSTALL PATH SYSTEM TO WD #7
- 12- INSTALL DITCHES FOR IRRIGATION SOUTH OF MESS #2

DECLASSIFIED

Authority: NDS 8808

C- SANITATION

- 1- CLEAN DRAINAGE DITCHES BEYOND FENCE
- 2- DIG SUMP FOR MESS #1
- 3- DIG SUMP FOR MESS #2
- 4- BURN COMBUSTIBLE TRASH
- 5- BURY CARBAGE
- 6- COLLECT, FLATTEN & DISPOSE OF TIN CANS
- 7- ISSUE FLY SWATTERS

D- GENERAL UTILITIES

- 1- COMPLETE BABISTRY
- 2- BUILD HORSE SHOE COURT & SHOES
- 3- REPAIR HERNIA TRUSS
- 4- REPAIR DUMP BUCKET STANDS
- 5- MAKE SHOVEL HANDLES
- 6- REPAIR LABORATORY DOOR

— OVER —

9. 4. 200.

- 7- BUILD RICE VAT FOR MESS. #2
- 8- BUILD LITTERS FOR RATION DETAIL
- 9- BUILD LITTERS FOR WOOD DETAIL
- 10- STRENGTHEN N-P WARD
- 11- BUILD DEVELOPER ROLL FOR X-RAY
- 12- REPAIR TOOLS
- 13- BUILD DOOR FOR MORGUE
- 14- BUILD GATE FOR MORGUE AREA
- 15- REPAIR LATRINE BOXES
- 16- BUILD TABLE, CHAIRS AND SHELVING FOR LIBRARY
- 17- REPAIR WINDOWS
- 18- SUPERVISE TOOL CHECK AND ISSUE
- 19- IMPROVISE GARDEN IMPLEMENTS
- 20- INSTALL TWO NEW URINALS

William J. Hartman
 Capt. C.E. 1111
 Insp. 1111111111

DECLASSIFIED
 Authority *NND883018*

Hospital Headquarters,
January 8, 1944.

SUBJECT: Wooden Boxes.

TO : The Commanding Officer, American Headquarters, Military Prison
Camp No. 1 of the Philippine Islands, Cabanatuan, P. I.

1. Request that the Camp Supply Officer turn over to the Hospital
four large wooden boxes, said boxes to be used for the ration run.

For the Commanding Officer:

C. S. MAUPIN,
Major, Medical Corps,
Adjutant.

DECLASSIFIED
Authority NND883018

10 47 p.p.

CAMP HOSPITAL
Military Prison Camp Number One
Cabanatuan, Nueva Ecija, P. I.

Nov. 29, 1944

Subject: Report of Activities, Hospital Utilities.

To: The Commanding Officer, Camp Hospital.

Report of activities of the Hospital Utilities Section, month of November, 1944, is submitted herewith:

Latrines: Flush latrines daily, police areas. Scrub latrine seats with disinfectant. Police urinal areas. Police septic tank areas, clean ditches.

Utilities: Daily police of area. Burn refuse, care of incinerator. Cut grass. Dig sump. Construct shelter for shower, hospital area. Police shower areas. Repair roofs, hospital area, general. Repairs, miscellaneous, buildings in hospital area. Repair bridges, main path. Delouse wards. Board up empty buildings, general area.

RALPH E. HIBBS
Captain, Medical Corps
Hospital Utilities Officer

DECLASSIFIED
Authority *NW88308*

October 19, 1944

SUBJECT: PLANS FOR THE MESS OF HOSPITAL AND OF
PERMANENT QUARTERS AREA.

1. The entire Camp and remaining personnel will mess at Mess number 1, beginning with supper this date.

2. The Hospital will mess according to previous plans.

3. The Permanent Quarters people will go to the Mess by Barracks, and after receiving their food will return to their area to eat.

4. The remainder of the out-going detail will also go the Mess in a group to receive their rations.

E. P. REED,
Major, M. C.

DECLASSIFIED
Authority NND88308

174
400

REPORT FROM CAMP HAWK
Camp Hawk, Navy. Esch. P. I. October 31, 1944.

Subject: Report of activities, Hospital Utilization Section.

To : The Commanding Officer, Camp Hospital 1, Military Prison, Esch. P. I.

1. Report of activities, Hospital Utilization Section, month of October, 1944, is submitted herewith:

LATRINES: Flush all latrines twice daily. Police all latrines in urinal areas. Scrub down latrine seats with disinfectant. Sprinkle areas of urinals and urinals. Daily inspection of septic tanks, police of sewage disposal ditches.

UTILITIES: Police of hospital area daily. Cut grass, clean ditches. Burn combustible refuse, hospital incinerator. Police dump areas. Repair sink, Hospital bldg #15. Repair shower platform, Hospital bldg #1. Board up empty wards, Hospital bldg #1. Repair urinal, Hospital head quarters. Repair conduit, hospital supply bldg. Construct new wash stove, burial detail. Haul medical supplies from Japanese area. Haul medical supplies from camp #1 dump area. Repair sink, hospital bldg #10. Repair well, Hospital bldg #10. Close empty barracks, upper camp area. Repair electrical line for E. N. T. clinic. Construct bench, Hospital #10. Repair door, Hospital library. Install rivetment, Upper latrine. Repair door, Hospital A-Rm. Repair sink, Det. Barracks. Install new door, Hospital bldg #15. Install urinal, Hospital latrine. Install window, Hospital bldg #4. Miscellaneous minor repair work, hospital area.

R. E. HIPBS

R. E. HIPBS,
Captain, Medical Corps
Hospital Utilization Officer

DECLASSIFIED
Authority *ND88308*

13
45 pva

October 17, 1944

TO: Doctor Suehiro.

SUBJECT: Suggested Plan For Hospital Mess.

1. It is requested that fifteen permanent quarters men be assigned to Mess No. 1 for duty. With the fifteen men remaining will make a total of thirty men. This Mess has twenty-three men at present, as it will be necessary to feed over 200 more men, and as ration detail must be available to carry rations, the extra men are needed. Permanent quarters men to be used are not strong and cannot do as much work as those leaving.

2. A new gate from the area where permanent quarters men are living into the hospital would facilitate feeding these men. A guard would be placed on the gate.

3. It is requested that the ranges in Mess No. 2 be moved to Mess No. 1 to provide hot water for treatments and sterilization. This would save wood now being used for this purpose.

E. P. REED,
Major, M. C.,

DECLASSIFIED
Authority NW88308

14 app

PLAN FOR CAMP AREA

1. It is very necessary that the Permanent quarters cases be removed from the present Barracks Numbers 1, 2, 3, and 4. There has been much trouble in the past with these people being too close to the Hospital.

2. The present Headquarters building will be necessary as a Permanent quarters Battalion Headquarters, Library and Medical Dispensary.

3. The attached drawing shows the suggested area to be included with the Hospital area in the new camp.

E. P. REED,
Major, M. C.

DECLASSIFIED
Authority NND88308

15
a/t
000

October 19, 1944

SUBJECT: PLANS FOR THE MESS OF HOSPITAL AND OF
PERMANENT QUARTERS AREA.

✓ 1. The entire Camp and remaining personnel will mess at Mess number 1, beginning with supper this date.

✓ 2. The Hospital will mess according to previous plans.

✓ 3. The Permanent quarters people will go to the Mess by Barracks, and after receiving their food will return to their area to eat.

✓ 4. The remainder of the out-going detail will also go the Mess in a group to receive their rations.

16
16

E. P. Reed

E. P. REED,
Major, M. C.

DECLASSIFIED
Authority *ND88308*

16 2/70

November 22, 1944

SUBJECT; PRESENT PLAN OF CAMP NO I.

TO : THE COMMANDING OFFICER, IMPERIAL JAPANESE ARMY HEADQUARTERS, MILITARY PRISON CAMP NO. I OF THE PHILIPPINE ISLANDS, Cabanatuan, P. I.

With the recent departure of 204 Permanently disabled men and 25 Medical Department men there has been a necessary change in the organization and Plan of this camp.

I. Permanent Quarters and Duty Group.

Barracks numbers 5, 9 and 10 are now empty.

The population of the remaining used barracks is as follows:

No. 6 - - 7	
No. 7 - - 12	
No. 11 - - 5	
No. 12 - - 43	
No. 13 - - 45	
No. 16 - - 2	
No. 17 - - 1	
P.O.W.# 1 - - 2	
P.O.W.# 2 - - 2	
Hqrs. - - - 2	TOTAL - 121

ORGANIZATION OF THIS GROUP:

COMMANDING OFFICER - - - REED, E. P., Major, MC
DETAILS OFFICER AND
ACTING ADJUTANT - - - KING, Ben, Capt. CMC

DECLASSIFIED

Authority NND 88308

17
2720

III. CAMP HEADQUARTERS.

COMMANDING OFFICER - - - - E. P. Reed, Major, MC
LIBRARIAN - - - - - Paul R. Wing, Major SC
LIBRARIAN ASSISTANT - - - R. W. Bliss, 2nd Lt.
PAYMASTER, SUPPLY and
COMMISSARY - - - - - Max M. McCoy, CY, USN.

E. P. REED,
Major, Medical Corps,
Commanding.

DECLASSIFIED
Authority *ND883018*

copy

This group furnishes about one half of the Kitchen crew in the Hospital Area, two Librarians, two Tailors, and other special duty men.

II. HOSPITAL.

No buildings have been made empty since last report, but the departure of twenty-five Medical Department men has brought the total down to forty. Three of these are used in the Camp Headquarters for administrative purposes, which further decreases the Medical Department men doing Medical work. All of the remaining Medical Department men are doing several jobs now and it is necessarily expected that the quality of medical care will be lowered.

The organization in respect to the Medical Officers remains the same.

COMMANDING OFFICER----- R. P. Reed, Major, MC
ADJUTANT- - - - - Ralph E. Hibbs, Captain, MC
MESS OFFICER - - - - - Denton J. Rees, Captain, DC

The Hospital (Medical Department Men) furnishes about one half of the Kitchen crew. The utilities and sanitation detail is furnished entirely by the Hospital for the whole camp. The gate guards between the Hospital and Duty area as well as the gate into the Amoebic Dysentery area are also furnished by the Hospital.

Population of the Wards and Barracks in Hospital Area:

No. 3 - - 33	No. 10 - - 28	No. 17 - - 19
No. 4 - - 11	No. 11 - - 39	No. 18 - - 5
No. 7 - - 67	No. 12 - - 40	No. 19 - - 4
No. 8 - - 63	No. 15 - - 68	No. 20 - - 3
No. 9 - - 5	No. 16 - - 2	No. 21 - - 3

TOTAL 390

DECLASSIFIED
Authority: NND 88308

24/9/68

Install new valve, pipe line, area of Hosp Bldg #3. Repair window, Hosp Bldg #8. Repair bench, Hosp Bldg #13. Repair 2 windows, Hosp Dispensary. Repair window, Hosp Bldg #5. Haul lumber from perimeter fence to kitchens, Police area of Hosp Bldg #13. Haul wood from group area to hosp kitchen. Fill in old hosp morgue bldg area. Clean main ditch, area of Japanese - hospital fence. Fill in ditches, area of old latrines. Install rivetment, area of Hosp Bldg #11. Haul Medical Supplies from Group area. Weekly police of entire hospital area for inspection.

~~W. F. Swanson~~

W. F. SWANSON,
Major, Medical Corps,
Hospital Utilities Officer.

DECLASSIFIED
Authority ND883018

Subject: Report of activities, Hospital Utilities, month
of September, 1944.

To: The Commanding Officer, Camp Hospital, Military
Prison Camp Number One.

The following report of activities of the Hospital
Utilities, month of September, 1944, is submitted herewith:

LATRINE CREW: Flush latrines daily, police of entire latrine
areas daily. Scrub down latrine boxes and
sinks with disinfectant once weekly. Repair latrine
covers when required. Clean and reshape ditches, areas of
latrine, as required. Inspect sewage-pools daily, check
drain ~~lines~~

UTILITIES CREW: Burn combustible refuse daily, police all
sumps daily. Spread ashes from hospital
mess, muddy or low walk areas. Cut grass and clean and re-
shape ditches, Dysentery area, daily. Cut grass and clean
and reshape ditches, area of Hospital #1, daily.

Construct benches, Hosp Bldg #10. Repair
culverts, Hosp Bldg #10. Repair fence, area of Detachment
latrine. Repair Hosp Chapel. Repair board walk, Hosp Sur-
gery. Repair door, Hosp Bldg #3. Repair water spigot, near
Hosp Bldg #10. Repair shower, Detachment, Hosp Bldg #17.
Install braces, Hosp Bldg #10. Construct table, Hosp Disp-
ensary. Repair fence, Dysentery area. Install culvert,
Hosp Library. Make wooden clogs for orthopedic patient,
Surgical Ward. Repair roof, Hosp Bldg #9. Repair roof,
Hosp Bldg #5. Repair culvert, Hosp Bldg #10. Construct
stools, Hosp Dispensary. Repair windows, roof, Hosp Bldg #5.
Repair fence, area of Hosp Bldg #10. Repair hydrant, near
Hosp Bldg #10. Repair roof, Hosp Bldg #5. Construct and
install bridge, Hosp Bldg #11. Repair barracks bucket, Med.
Det. Repair fence, area of Hosp Bldg #8. Repair roof, Hosp
Bldg #5. Construct file cabinet, Hosp. Headquarters. Repair
roof, Hosp Bldg #10. Repair board walk, Hosp Bldg #9. Repair
board walk, Hosp Bldg #11. Construct plunger for latrines.
Repair roof, Hosp Bldg #10. Repair culvert, Hosp Bldg #14.
Repair roof, Hosp Bldg #14. Inspect and repair of culverts,
general hosp area. Install rivetment, reshape ditch, Hosp
Bldg #11. Repair hydrant, near Hosp Bldg #10. Repair doors
Hosp Headquarters. Repair cross-braces, Hosp Bldg #10.

DECLASSIFIED

Authority ND 883018

I - SANITATION

- A - FLUSH & PUDDLE LATRINES DAILY
- B - WASH LATRINE SEATS DAILY
- C - DISINFECT LATRINE SEATS TWICE WEEKLY
- D - POLICE LATRINE AREAS DAILY
- E - REPAIR LATRINE SEAT COVERS AS NECESSARY
- F - SPREAD ASHES AROUND URINALS
- G - REPAIR DYSENTERY URINAL BOX
- H - GENERAL POLICE FOR INSPECTIONS
- I - BURN DRY GARBAGE IN INCINERATOR
- J - BURY WET GARBAGE IN SUMPS
- K - DIG NEW SUMP NON-DYSENTERY AREA
- L - DELOUSE BUILDINGS IN ORDER INDICATED:
#11, #13, #7, #6, #15, #12, #3, #4, #7, #13, #5, #8.

II - BEAUTIFICATION

- A - BUILD UP LOW PLACES IN MAIN PATHS WITH ASHES
 - 1 - EAST WD #5
 - 2 - WEST WD #11
 - 3 - SOUTH WD #11
 - 4 - EAST OF BARBER SHOP
 - 5 - EAST WD #7
 - 6 - WEST WD #13
 - 7 - NORTH WD #8
 - 8 - WEST BKS. #17
- B - CUT GRASS IN ORDER INDICATED:
 - 1 - AROUND HQS. & OFF. QTRS. AREA
 - 2 - " BLDG #16, MAIN DITCH, WD #9, WEST FENCE
 - 3 - DYSENTERY AREA
 - 4 - EAST HOSPITAL & LATRINE AREA
 - 5 - HOSP. SUPPLY, MESS HALL, OFF QTRS. AREA
 - 6 - MAIN DITCH & ALONG WEST FENCE
 - 7 - DYSENTERY AREA
 - 8 - EAST HOSP. & LATRINE AREA
 - 9 - BLDG #16 & MAIN DITCH AREA
 - 10 - DYSENTERY AREA
 - 11 - EAST HOSPITAL AND LATRINE AREA
 - 12 - HQS. AND OFF. QTRS. AREA
- C - FILL IN LOW PLACES DYSENTERY AREA

DECLASSIFIED

Authority N888308

(OVER)

- D- LEVEL DYSENTERY TINKO AREA
 E- EXTEND MAIN PATH TO NEW NORTH PERIMETER FENCE
 F- LEVEL & POLICE OLD SITE OF WD #13
 G- INSTALL DRAINAGE DITCHES AROUND NEW LATRINES
 H- CLEAN OUT DITCHES AS INDICATED:
- | | | | |
|------------------------|---------------------|--------------|-----------|
| 1- OFF. QTRS. | 4- DELOUSER | 7- WD #12 | 10- WD #5 |
| 2- DISPENSERY & WD #12 | 5- OP. ROOM & WD #8 | 8- MAIN PATH | 11- WD #7 |
| 3- MAIN DITCH | 6- WD #9 | 9- DIS. AREA | 12- WD #6 |

III- GENERAL UTILITIES -

A- MOVE BLDG #13 TO NEW SITE

- | | |
|-------------------------------------|-------------------------------|
| 1- REMOVE BAYS & BRACE FOR MOVING | 4- INSTALL FLOOR & BAYS |
| 2- PREPARE NEW SITE | 5- LEVEL & INSTALL FOOTING |
| 3- CARRY 60' x 20' BLDG TO NEW SITE | 6- DITCH, LEVEL & POLICE AREA |

B- MOVE 3 LATRINES TO NEW SITES

- | | |
|--------------------------------------|-------------------------------------|
| 1- DIG NEW PITS FOR SEPTIC TANK | 5- INSTALL CONNECTING SHUTES |
| 2- INSTALL FORMS, BAFFLES, AND COVER | 6- BUILD MOUND AROUND BOXES |
| 3- BUILD UP MOUND FOR LAT. BOXES | 7- MOVE COVERS ON TO MOUND |
| 4- DIG UP & MOVE SHUTES & BOXES | 8- LEVEL, BRACE, INSTALL STEPS ETC. |

C- MOVE MORGUE TO NEW SITE

D- MOVE CHAPEL TO NEW SITE

E- DISMANTLE SOUTH CHAPEL & OLD GUARD HOUSE FOR SALVAGE

F- REPAIR 8 BUCKETS

G- " HQS. CLOTHESLINE

I- INSTALL CLOTHESLINE FOR WD #3, #4, #12, #13.

J- REPAIR STEPS BKS #17

K- CONSTRUCT 15 FLOOR CLEANERS

L- REPAIR CHAPEL ROOF

M- DAILY FENCE CHECK & REPAIR

N- REPAIR 6 WINDOWS

O- CONSTRUCT 2 BACK RESTS

P- " 2 TABLES (DISP)

Q- " T ARMS FOR WDS.

R- MAKE LATRINE PUDDLER

S- " SHOVEL HANDLE

T- REPAIR SPIGGOTS & SHOWER

U- REPAIR FRACTURE BOX

V- CONSTRUCT STOOL (DISP)

W- REPAIR LEG SPLINT

X- MOVE & REPAIR GUARD

SHACK AT MAIN GATE

Y- TOOL CHECK, ISSUE, AND

MAINTENANCE.

Alison L. Hartman
 CAPT. C.I.E.
 HOSP. UTILITIES OFF.

DECLASSIFIED

Authority: NND 88308

D-10001 DYSENTERY TINKO AREA
II-BEAUTIFICATION (cont)

Hospital Headquarters,
August 10, 1944.

SUBJECT: Request for Locks.

TO : Lieut. Yamaji, Imperial Japanese Army. (Thru:
American Quartermaster, Prisoner of War Office).

1. Respectfully request that the Hospital be furnished
two locks and two keys to be used for the purpose of locking
up welfare foods in the Hospital Mess.



W. D. NORTH,
Lt. Col., Medical Corps,
Chief of Hospital.

DECLASSIFIED
Authority NND883018

22 9/20

I- SANITATION

- A- FLUSH LATRINES DAILY
- B- WASH LATRINE SEATS DAILY
- C- DISINFECT LATRINE SEATS WEEKLY
- D- DIG NEW SUMP FOR HOSP. MESS
- E- INSTALL NEW MESS SUMP, COVER OLD SUMP, & POLICE
- F- MAINTAIN NON-DYSENTERY SUMP
- G- DISPOSE OF TIN CANS
- H- OPERATE DELOUSER IN CLEMENT WEATHER

II- BEAUTIFICATION

- A- CLEAN DITCHES ON MAIN EAST WALK
- B- DIG DRAINAGE DITCHES AROUND WD #8
- C- CLEAN OUT MAIN DRAINAGE DITCH
- D- CLEAN DITCHES IN SOUTH HOSP. AREA.
- E- GENERAL POLICE EACH WED. & SAT.
- F- CUT GRASS IN DYSENTERY AREA
- G- " " ALONG LATRINE LINE
- H- " " AROUND OFFICERS QUARTERS
- I- " " " MESS
- J- " " IN NON-DYSENTERY AREA
- K- " " UNDER & AROUND CLINIC BLDG.

III- GENERAL UTILITIES

- A- REPAIR MESS RICE VAT
- B- " " DUCK BOARDS WD. #12
- C- INSTALL CABINET FOR DENTAL CLINIC
- D- REPAIR NINE (9) FOOT BRIDGES
- E- " " SIX (6) BUCKETS
- F- " " TWO (2) MESS LITTERS
- G- REMODELED TABLE, LID, & STAND FOR MESS.
- H- INSTALL PLUMBING TO "QUAN" STOVE
- I- HELP MOVE DENTAL CLINIC TO NEW LOCATION (WD #5)

DECLASSIFIED
Authority: NND 88308

- J- REMOVE PARTITION IN WD #12
- K- MOVE WARD SURGEONS OFFICE TO END OF WD #12
- L- INSTALL SHELVES, WINDOWS, DOOR, DRAIN ETC, IN NEW DENTAL & E.E.N.T. CLINIC.
- M- REPAIR MESS ROOF & PATCH WITH CANVAS, CARDBOARD AND BOARDS.
- N- REMOVE WOODEN FLOOR FROM SUBSISTENCE BLDG.
- O- INSTALL RACKS AND TABLE FOR SUBSISTENCE.
- P- MOVE SUPPLY SCALES
- Q- MOVE TOOL RACK AND UTILITIES EQUIPMENT.
- R- CONSTRUCT A NEW & REPAIR OLD CAULDRON COVERS.
- S- REPAIR WINDOW OPERATING ROOM
- T- " DOOR TO X-RAY.
- U- " MESS SUMP COVER
- V- " WALK IN FRONT OF MEDICAL SUPPLY
- W- MOVE SURGICAL TAPE RACK
- X- REPAIR SOUTH WALL BLDG #1
- Y- GENERAL SPOT ROOF REPAIR
- Z- TOOL ISSUE, CHECK, AND MAINTENANCE.

DECLASSIFIED
 Authority NND883078

Alison L. Hartman
 CAPT. C.E.
 HOSPITAL UTILITIES OFF.

Hospital Headquarters,
August 7, 1944.

SUBJECT; Fire Wood.

TO : Lieutenant Yamagi, Commanding Officer of American Prisoners.

1. It is respectfully requested that sufficient fire wood be made available to the Hospital Area to permit sterilization of mess equipment in the Dysentery Area as per Japanese instructions.

2. The Hospital daily minimum requirement needed to carry out the necessary cooking and sterilization as prescribed by the Japanese is one (1) load of wood per day, whereas recently we have received less than this quantity which has necessitated the abandonment of the sterilization of mess equipment in the Dysentery Area.

DECLASSIFIED
Authority NND883018

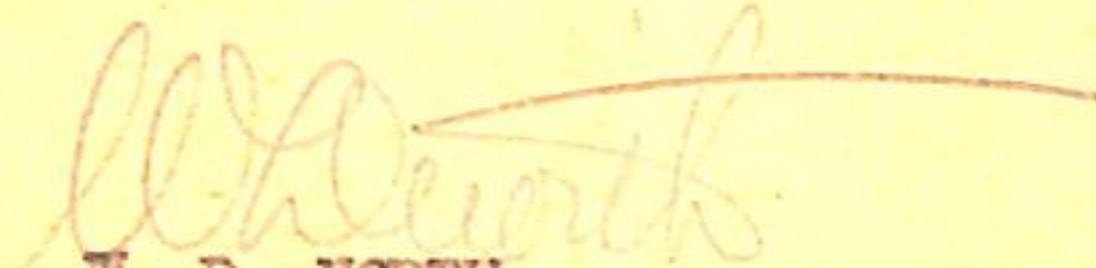
W. D. NORTH,
Lt. Col., Medical Corps,
Chief of Hospital.

27910

1 July 1944.

Subject: Request for Authority to Dig Garbage Pit.

To: Commanding Officer, Military Prison Camp #1.
(Thru: C.O., American Prison Headquarters)

Respectfully request permission to dig a garbage pit in the vicinity of the incinerator, four (4) meters deep by two (2) meters by two (2) meters.

For the Group Commander:

G. B. GROSS,
Major, Infantry
Adjutant.

American Prisoner Headquarters, Military Prison Camp No. 1 of the Philippine Islands, Cabanatuan, P. I., July 1, 1944. To: Commanding Officer, Military Prison Camp No. 1 of the Philippine Islands, Cabanatuan, P. I.

Forwarded, recommending approval.

CURTIS T. BENCHER
Lieutenant-Colonel, U. S. Marine Corps
Commanding.

Permission received - Digging to start Monday, 7/3/44

e→D

T. B.

DECLASSIFIED
Authority NU883018

25 9/1/44

- No. ~~72~~ Japanese kitchen
- ~~73~~ Japanese kitchen
- ~~74~~ Japanese kitchen
- ~~85~~ Japanese kitchen
- ~~86~~ Japanese kitchen

~~84~~ OTT, H. I. 1stLtUSA Butcher detail

~~75~~ Hospital Runner

~~76~~ Medical Headquarters runner

~~70~~ Main Gate Sentry

~~71~~ Main Gate Sentry

47 Rice Captain, Wood Detail.

G. H. REYNOLDS,
Major, F. A.,
Adjutant.

Total Attendance 87

(10)

*31
45
10
87*

26 ant

DECLASSIFIED
Authority *NDS88308*

57	LYNCH, T.J.	Civilian	Interpreter
58	VOLNY, A.G.	Civilian	Interpreter
60	ENGELHART, C.C.	Lt-ColUSA	Interpreter, Farm
59	HOTSIENPILLER, W.R.	Civilian	Interpreter
57	BOYCE, J.T.	SgtUSA	Interpreter, Airport
33	VINTON, F.S.	PfcUSMC	Power & Pump House
34	MILLER, R. N.	CaptUSA	Power & Pump House
35	HEDRICK, R. F.	1stLtUSA	Power & Pump House
36	SIMPSON, J. R.	S/SgtUSA	Power & Pump House
37	LEE, J.E.	BoanUSN	Power & Pump House
38	STURGELL, S.R.	ElecUSN	Power & Pump House
39	JARRELL, L.F.	EMlcUSN	Power & Pump House
40	CORBITT, L.O.	Civilian	Power & Pump House
41	MARTIN, A. R.	Civilian	Power & Pump House
42	STICKMAN, W.F.	EMM USN	Power & Pump House
65	BRAVENS, D. F.	SgtUSA	Runner, Japanese Headquarters
66	MOORE, C.C.	S/SgtUSA	Runner, Japanese Headquarters
11	HOUSKIE, C.	CorpUSA	Tailor Shop, Japanese area
12	TOMLINSON, D.E.	PfcUSMC	Tailor Shop, Japanese area
13	ARNOLD, H. S.	Civilian	Tailor Shop, Japanese area
43	PROLIAOSKI, S.J.	CorpUSA	Tailor Shop, Japanese area
14	LUCAS, J.L.	CaptUSA	Telephone crew
15	KEASEY, R.A.	1stLtUSA	Telephone crew
16	McANERNEY, J.M.	1stLtUSA	Telephone crew
17	BROWNING, H.B.	Civilian	Telephone crew
18	HEYDA, C. W.	Civilian	Telephone crew
19	OVERBECK, R.S.	Civilian	Telephone crew
4	CLANSON, F.	S/SgtUSA	Toolhouse, Japanese area
5	KRISTICH, L.	S/SgtUSA	Toolhouse, Japanese area
6	FOLEY, Gerald D.	SgtUSA	Toolhouse, Japanese area
7	IGNASZEWSKI, L.L.	PfcUSA	Toolhouse, Japanese area
8	LEMKE, S.	PfcUSA	Toolhouse, Japanese area
9	MILLER, W. T.	PvtUSA	Toolhouse, Japanese area
10	HERNDON, E.	PvtUSA	Toolhouse, Japanese area
56	RICKETS, J.F.	CorpUSA	Watch repairman, Japanese area
2	BURSON, C.E.	CaptUSA	Wood distribution, American area
3	GERTH, H.F.	1stLtUSA	Wood distribution, American area
1	DAVIS, F.A.	LtCdrUSN	Wood Detail, Work Captain
87	NIELSON, L.H.	PvtUSA	Woodchopper, Japanese kitchen
50	BISHOP, J.J.	PfcUSMC	Woodchopper, Japanese kitchen
51	HART, L.	Civilian	Woodchopper, Japanese kitchen
52	GARMAN, G.S.	PfcUSA	Woodchopper, Japanese kitchen
53	NELSON, W.A.	PvtUSA	Woodchopper, Japanese kitchen
54	RUSSELL, J.E.	PvtUSA	Woodchopper, Japanese kitchen

DECLASSIFIED
 Authority NND88308

9 July, 1944

MEMORANDUM FOR: Mr. Masada.

1. Listed below, by detail, are the personnel having white arm-bands authorizing them to pass the Main Gate:

No. 62	Airport ration detail		
68	Airport ration detail		
69	Airport ration detail		
63	HERTZ, W.W.	MajUSA	Camp Prison Officer
64	HERTZ, W.W.	MajUSA	Camp Prison Officer
79	ABSTON, A.A.	CaptUSA	Camp Work Details
80	CORNWALL, B.R.	CaptUSA	Camp Work Details
81	GULICK, John M.	CaptUSA	Camp Work Details
82	SHILEY, R. M.	CaptUSA	Camp Work Details
83	AMES, G. R.	CaptUSA	Camp Work Details
77	Camp Supply		
78	Camp Supply		
52	McCoy, M.M.	CY USN	Clerk, Japanese Headquarters
44	SIKES, Joe H.	SgtUSA	Carabao corral
45	MEESE, W. G.	Civilian	Carabao Corral
46	VARELAS, A. G.	Civilian	Carabao corral
48	FOWLKES, H. C.	ACM USN	Duck farm
49	ANDERSON, R.A.	CorpUSMC	Duck farm
20	AMMONS, Cecil	S/SgtUSA	Garage
21	FOGERTSON, J.D.	S/SgtUSA	Garage
22	WHITAKER, W.G.	S/Sgt	Garage
23	BOWMAN, T.C.	Sgt	Garage
24	PHARR, Alfred O.C.	Sgt	Garage
25	TAYLOR, L.V.	Sgt	Garage
26	TUBBLEVILLE, H.M.	Sgt	Garage
27	TUBBLEVILLE, O.	Sgt	Garage
28	SNELLEN, J.P.	Corp	Garage
29	HILSHORST, A.L.	Pvt	Garage
30	BELL, C.F.	Corp	Garage
31	KOEHLER, L.	Pfc	Garage
55	PENOLA, J.L.	CWT USN	Gardener Japanese area

3
28 94 100

DECLASSIFIED
Authority NND883078

25 July, 1944

SUBJECT: Duties of Camp Construction and Utilities Detail.

To: Commanding Officer, Prisoner of War Office.

1. The Prisoner of War Office Construction and Utilities Detail consists at present of:

- 1 - Field Officer, in charge
- 1 - Company Officer, assistant
- 4 - Carpenters

2. Their duties are general repair and maintenance of the following buildings and facilities, including roofs and roof nets, windows, floors, and underpinning:

- a. Prisoner of War Office building, including facilities for preparing and filing records, orders, and statistics.
- b. Camp Dental Infirmary.
- c. Prisoner of War Office Staff Officers' quarters.
- d. Camp Library.
- e. Camp Supply warehouse and carabao carts.
- f. Camp Commissary warehouse.
- g. Rice Mill.
- h. Truck drivers and mechanics quarters.
- i. Camp Tailor and Cobbler Shop.
- j. Camp Theatre and projection booth.
- k. Camp Medical Supply warehouse.
- l. Fences between Divisions.
- m. Repair of leaking faucets, valves, and showers throughout Camp.

3. Their duty hours are from 7:00 a.m., to 11:00 a.m., and 2:00 p.m., to 5:00 p.m., every day except Sunday, with occasional emergency work outside of these hours and on Sunday.

4. In addition to the above, they are frequently called on for work in the Japanese Camp, for which they are usually given class "A" ration.

F. S. CONATY,
Lt-Col., QMC., U.S.A.,
Utilities Officer.

DECLASSIFIED
Authority NND883078

29 of 40

1- SANITATION

- A- FLUSH LATRINES DAILY
- B- WASH LATRINE SEATS DAILY
- C- COLLECT & DISPOSE OF GARBAGE
- D- SMASH TIN CANS
- E- CLEAN MAIN DRAINAGE DITCHES

2- BEAUTIFICATION

- A- CLEAN DITCHES AROUND WD #9
- B- " " " " Hqs.
- C- FILL DITCH BETWEEN WD #7 & WD #8
- D- DIG DRAINAGE DITCH FROM WD #8
- E- CLEAN DITCHES WD #9
- F- CUT GRASS SOUTH OF WD #5
- G- " " " " AROUND DELIVERY
- H- " " " " Hqs.
- I- " " " " SOUTH OF BLDG #18
- J- " " " " NORTH " " "
- K- " " " " AROUND CLINIC BLDG
- L- " " " " DYSENTERY AREA
- M- GENERAL POLICE TWICE WEEKLY FOR INSPECTION.

3- GENERAL UTILITIES

- A- REPAIR BAYS MESS #1
- B- " " " " WD #4
- C- " " " " WD #6
- D- " " " " WD #7
- E- " " " " WD #8
- F- MOVE DYSENTERY FENCE
- G- MOVE DYSENTERY GUARD SHACK
- H- INSTALL TWO BRIDGES FOR WD #5
- I- BUILD CLOTHESLINE FOR WD #2
- J- " " " " INSIDE OF SURGERY
- K- REPAIR " " FOR WD #4
- L- " " BRIDGE IN FRONT OF Hqs.
- M- MAKE & ISSUE 7 PRS. SKIVIES
- N- PUT UP RAIN BREAK IN SURGERY
- O- MAKE 2 LITTERS FOR RATION DETAIL
- P- REPAIR WINDOWS BKS. #4 LIBRARY, & BKS. #19
- Q- REPAIR TWO CAULDRONS FOR MESS
- R- REMOVE BAYS FROM WEST END OF WD #5 AND PREPARE FOR DENTAL CLINIC
- S- TOOL ISSUE, MAINTENANCE & INSPECTION

DECLASSIFIED
Authority: ND 883078

300/100

William L. Hartman
Capt. C. E.
Head, Utilization Dept.

June 14, 1944.

SUBJECT: Light & Water For Dental & EENT Clinic.

TO : Dr. Suehiro, Surgeon, Imperial Japanese Army, Military Prison Camp
No. 1 of the Philippine Islands, Cabanatuan, P. I.

1. Respectfully request permission to transfer the light and water installations from the former Dental and EENT Clinic in Building #9 to its new location in Building #5.

For the Chief of Hospital:

E. R. Wernitznig

E. R. WERNITZNIG,
Major, Medical Corps,
Executive Officer.

DECLASSIFIED

Authority *NND883018*

3/1
act
pp

Hospital Headquarters,
June 14, 1944.

SUBJECT: Light & Water For Dental & ENT Clinic.

TO : Dr. Suehiro, Surgeon, Imperial Japanese Army, Military Prison Camp
No. 1 of the Philippine Islands, Cabanatuan, P. I.

1. Respectfully request permission to transfer the light and water
installations from the former Dental and ENT Clinic in Building #9 to its
new location in Building #5.

For the Chief of Hospital:

E. R. WERNITZNIK,
Major, Medical Corps,
Executive Officer.

DECLASSIFIED
Authority NND883018

32
at
9/20/88

Headquarters,
June 14, 1944.

SUBJECT: Door in Dental Clinic, Building #5.

TO : Dr. Suehiro, Surgeon, Imperial Japanese Army, Military Prison Camp
No. 1 of the Philippine Islands, Cabanatuan, P. I.

1. Respectfully request permission to construct a new doorway on
the north side of Building #5 to permit entrance into the Dental and ENT
Clinic.

For the Chief of Hospital:

E. R. Wernitznig
E. R. WERNITZNIG,
Major, Medical Corps,
Executive Officer.

DECLASSIFIED
Authority *ND883018*

33
at
top

No.	Name	Rank	Group	Hrs	Assignment
52	BRENNAN, Raymond	Pvt	I	12	Woodchopper
53	GARMAN, George S.	Pfc	I	12	Woodchopper
54	NELSON, Wayne A.	Pvt	I	8	Woodchopper
55	RUSSELL, James E.	Pvt	I	12	Woodchopper
56	AMMONS, Cecil	S/Sgt	I	3-5	Mechanic & Truckdriver
57	FOGHERSON, Jack D.	S/Sgt	I	3-5	Mechanic & Truckdriver
58	WHITAKER, Wilfred G.	S/Sgt	I	5-5	Mechanic & Truckdriver
59	BOWMAN, Thomas C.	Sgt	I	3-5	Mechanic & Truckdriver
60	PHARR, Alfred O.C.	Sgt	I	3-5	Mechanic & Truckdriver
61	TAYLOR, Lewis V.	Sgt	I	3-5	Mechanic & Truckdriver
62	TUBBLEVILLE, "H" "M"	Sgt	I	3-5	Mechanic & Truckdriver
63	TUBBLEVILLE, Oscar	Sgt	I	3-5	Mechanic & Truckdriver
64	SNELLEN, John P.	Corp	I	3-5	Mechanic & Truckdriver
65	HILSHORST, Arthur L.	Pvt	I	3-5	Mechanic & Truckdriver
66	BELL, Chunkie F.	Corp	I	3-5	Mechanic & Truckdriver
68	MC GORMACK, William M.	Corp	I	3-5	Mechanic & Truckdriver
69	KOEHLER, Linroy	Pfc	I	3-5	Mechanic & Truckdriver
70	VINTON, Fred S.	Pfc	I	1	Power & Pumphouse
71	MILLER, Robert N.	Capt	I	1	Power & Pumphouse
72	HEDRICK, Richard F.	1stLt	I	1	Power & Pumphouse
73	SIMPSON, John R.	S/Sgt	I	1	Power & Pumphouse
74	LEE, Jesse E.	Bos'n	I	1	Power & Pumphouse
75	STURGELL, Stephen R.	Elec.	I	1	Power & Pumphouse
76	JARRELL, Lee F.	EMlc	I	1	Power & Pumphouse
77	HELMICK, Raymond A.	Sgt	I	1	Power & Pumphouse
78	CORBITT, Lewil O.	Civ	I	1	Power & Pumphouse
79	MARTIN, Albert R.	Civ	I	1	Power & Pumphouse
80	CARBOY, Joseph M. <i>Phillips Breeds P</i>	Sgt	I	12	Carabao Corral <i>Phillips Breeds S</i>
81	MC GROSKEY, Adam M.	Pvt	I	12	Carabao Corral
82	SIKES, Joe H.	Sgt	I	3-5	Carabao Corral
83	MEESE, William G.	Civ	I	6	Carabao Corral
84	VARELAS, Anastasios G.	Civ	I	6	Carabao Corral
85	DALEY, John P.	Pvt	I	9	Carabao Corral
87	WILSON, Wesley W.	SMlc	I	5	Gardener
88	CLARK, Roy W.	Corp	II	6	Orderly
89	GOEMAN, James H.	Pfc	I	12	Gardener
90	KATCHUCK, Alexander	Pvt	II	1	Gardener
#52	Hart, Louis	Cr	I		Woodchopper

Retired members of individuals

Leaving Service. 79

- # 36 - Hospital Runner
- 37 - Mail Rg Runner
- 38 - Supply
- 39 - Supply
- 40 - Wood Detail
- 35 *Walter*

DECLASSIFIED
Authority *NND88308*

25 June, 1944

MEMORANDUM FOR GROUP COMMANDERS:

1. Japanese Headquarters requires a report on the number of men working in this Camp tomorrow, June 26th. Report will be prepared in the following form:

DETAIL	Line Off	Line Enl	Total	Med Off	Med Enl	Total	GRAND TOTAL
--------	----------	----------	-------	---------	---------	-------	-------------

Schedule "A"
 JAPANESE DETAILS - Ordered by Camp Work Details Office and worked six hours.

Schedule "B"
 JAPANESE DETAILS - Ordered by Camp Work Details Office and worked less than six hours.

Schedule "C"
 JAPANESE DETAILS - Authorized by Japanese Headquarters, but work in American Area (not to exceed authorized number), and worked six hours.

Schedule "D"
 JAPANESE DETAILS - Authorized by Japanese Headquarters, but work in American Area (not to exceed authorized number), and worked less than six hours.

Schedule "E"
 ALL DETAILS ORDERED BY AMERICAN PRISONER HEADQUARTERS OR GROUP HEADQUARTERS -(To include those in excess of authorized Japanese allowance); who worked six hours.

Schedule "F"
 ALL DETAILS ORDERED BY AMERICAN PRISONER HEADQUARTERS OR GROUP HEADQUARTERS -(To include those in excess of authorized Japanese allowance), who worked less than six hours.

2. Reports will be in American Prisoner Headquarters by 4:30 p.m., tomorrow, June 26th.

BY ORDER OF LIEUTENANT COLONEL BEECHER:

G. H. Reynolds
 G. H. REYNOLDS,
 Major, F. A.,
 Adjutant.

DISTRIBUTION:
 Group I 700 Hosp 100
 Group II _____
 Camp Wk Det 700
 Orig to file. 700

DECLASSIFIED
 Authority: ND 883018

34
 9700
 508

Col Beecher
Major Tracy

1- SANITATION

- A- FLUSH LATRINES TWICE DAILY
- B- WASH LATRINE SEATS DAILY
- C- INSTALL STEPS TO LATRINES
- D- KILL INSECTS AROUND LATRINES WITH BOILING WATER
- E- REPLACE WORNOUT SEAT COVERS
- F- COLLECT AND DISPOSE OF GARBAGE,
- G- START DIGGING NEW DYSENTERY AREA SUMP.

2- BEAUTIFICATION

- A- CUT GRASS OVER ENTIRE HOSPITAL AREA
- B- CLEAN DITCHES BACK OF SURGICAL WARD
- C- " " " " AROUND BLDG # 18
- D- " " " " " " DELOUSER
- E- " " " " " " MAIN DRAINAGE DITCHES
- F- REMOVE IRRIGATION DAMS
- G- GRAVEL WALK WEST OF WD #12
- H- CLEAN DITCHES IN DYSENTERY AREA

3- GENERAL UTILITIES

- A- REPAIR ROOF ON SENTRY BOXES
- B- " " " " WD #11, #12, #20, HQS, #6, #8 AND #13.
- C- REPAIR CLOTHESLINES
- D- REPAIR FENCES
- E- REPAIR WALK IN FRONT OF CLINIC
- F- REMOVE COMMISSARY PLATFORM
- G- INSTALL PARTITION WD #9
- H- REPAIR WINDOWS: WDS. 4, 8, 13, MESS #1, 18, CLINIC, #9, #7, #5, #15, MESS #2.
- I- REPAIR 6 BUCKETS.
- J- REPAIR FOOT BRIDGES.
- K- BUILD LABORATORY STORAGE BOX
- L- REPAIR SHELVES IN OPERATING ROOM
- M- INSTALL RAIN BREAK IN X-RAY ROOM
- N- REPAIR 4 CAULDRONS FOR MESS #2
- O- INSTALL SHELVES FOR FEET CLINIC
- P- PUT LATCHES ON WINDOWS & DOORS AT HQS.
- Q- RAIN BREAK FEET CLINIC WALLS.
- R- " " " " MED. SUPPLY " "

S- TOOL INSPECTION AND MAINTENANCE AND ISSUE.

36

5/10/50

A. L. Hartman
CAPT. S.E. HOLD. 21st. OFF.

DECLASSIFIED
Authority: NND 88308

May 9, 1944.

LIST OF PASS NUMBERS OF SPECIAL DUTY PERSONNEL WHO PASS THROUGH THE MAIN GATE TO WORK ON THE JAPANESE SIDE:

Pass No.	Name	Rank	Group	Bks	Assignment
2	CLAWSON, Floyd	S/Sgt	II	5	Toolhouse
3	KRISTICH, Louis	S/Sgt	II	5	Toolhouse
4	HOLLINGSWORTH, Ralph M.	Sgt	I	10	Toolhouse
5	GORDEN, Kenneth R.	Pfc	I	10	Toolhouse
6X	DNASZENSKI, Louis L.	Pfc	I	10	Toolhouse
7X	LEE, Steve	Pfc	I	10	Toolhouse
8X	MILLER, William T.	Pvt	I	29	Toolhouse
9X	LILLARD, "JIM"	Pvt	II	2	Toolhouse
10X	HEARD, James M.	Corp	I	3-5	Tailor Shop
11	HOUSKIE, Clarence	Corp	I	7	Tailor Shop
12X	TOMLINSON, Darrell E.	Pfc	I	12	Tailor Shop
13	ARNOLD, Horatio S.	Civ	I	7	Tailor Shop
14	DURAN, David J.	S/Sgt	I	10	Commissary
15	MONTAYA, Orlando	Sgt	I	10	Commissary
16	ROSSLER, Paul A.	S/Sgt	I	10	Orderly
19	NOYES, Robert C.	Pvt	I	9	Bathhouse <i>visitors</i>
20	HOTSENPILLER, Winston R	Civ	II	5	Interpreter
21	LYNCH, Thomas T.	Civ	I	1	Interpreter
22	VOLNY, Anthony G.	Civ	I	1	Interpreter
23	MC COY, Max M.	CY	I	1	Clerk
24	LUCAS, John L.	Capt	I	28	Telephone crew
25	KEASEY, Richard A.	1stLt	I	28	Telephone crew
26	MC ANERNEY, John M.	1stLt	I	28	Telephone crew
27	BROWNING, Horace B.	Civ	I	36	Telephone crew
28	HEYDA, Charles W.	Civ	I	35	Telephone crew
29	OVERBECK, Robert S.	Civ	I	35	Telephone crew
30	PENOLA, James L.	CWT	I	29	Gardener
31	HARRICK, Eugene B.	Pvt	I	3-7	Horseshoer
32	BURNS, Jonathan P.	Pfc	I	3	Commissary
34	ROSELL, Frank G., Jr	P1Sgt	I	12	Commissary
35	RICKETTS, Junious F.	Corp	I	10	Watch repairman
36	CARROLL, Arthur	Pfc	I	10	Kitchen
37	LYONS, John R.	Pfc	I	12	Kitchen
39	WALLACE, Oscar	Sgt	I	10	Kitchen
40	LEE, Victor M.	Pfc	I	10	Kitchen
41	PACK, Okey D.	Pfc	I	10	Kitchen
43	WHITE, Claude W.	Pfc	I	10	Kitchen
44	WHITE, Stanley W.	Pfc	I	10	Kitchen
45	BUCHNER, Edward W.	Pvt	I	10	Kitchen
46	STICKMAN, William F.	CMM	I	1	Power & Pumphouse
50	Miller, Robert L.	EMicrle	I	10	Kitchen
51X	BISHOP, John J.	Pfc	I	3-4	Woodchopper <i>ok</i>

DECLASSIFIED
Authority: NND 883078

#19 Nielsen, Laman H Pot I Woodchopper
37 eff

HEADQUARTERS GROUP I

June 2, 1944.

SUBJECT: Digging of Hole.

TO: Commanding Officer, Philippine Military Prison Camp
Number One, Cabanatuan, P. I.

Respectfully request permission to dig a hole four feet by three feet by four feet (4x3x4) near the Group incinerator in order to obtain earth suitable for making "dobie" brick used in the repair of the mess stoves. The hole will be filled in when necessary earth is obtained.

Leo C. Paquet
LEO C. PAQUET,
Lt. Colonel, Inf.,
Group Commander.

1st Ind.

American Prisoner Headquarters, Military Prison Camp
Number I of the Philippine Islands, Cabanatuan, P. I.,
June 2, 1944. To: Commanding Officer, Military Prison
Camp No. I of the Philippine Islands.

Forwarded, approval recommended.

*Approved
6/5/44*

CURTIS T. BEECHER,
Lieutenant Colonel, U.S. Marine Corps,
Commanding.

DECLASSIFIED
Authority *ND883078*

~~HEADQUARTERS~~
MILITARY PRISON CAMP NO. 1 OF THE PHILIPPINE ISLANDS
CABANATUAN, P. I.

May 28, 1944

SUBJECT: Repair of Latrine

TO: Commanding Officer, Military Prison Camp No. 1 of the
Philippine Islands, Cabanatuan, P. I.

1. The issue of the following supplies is requested to
repair the troughs under the seats of latrines:

2 bags cement

Respectfully,

CURTIS T. BEECHER
Lieutenant-Colonel, U. S. Marine Corps
Commanding.

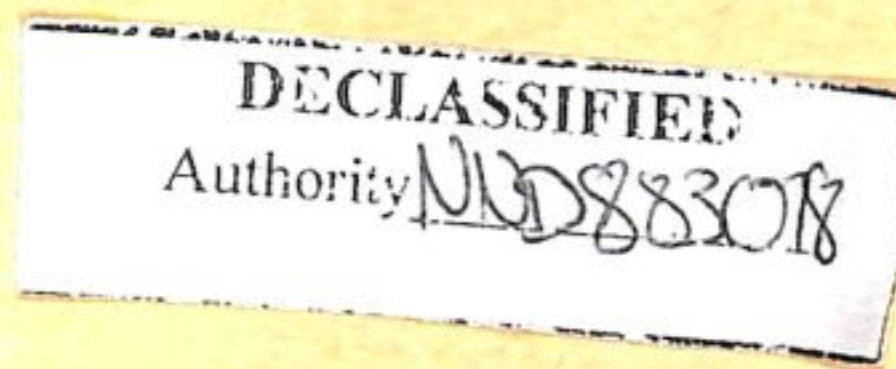

39 4⁺ PCP

AMERICAN PRISONER HEADQUARTERS
MILITARY PRISON CAMP NO. 1 OF THE PHILIPPINE ISLANDS
CABANATUAN, P. I.

May 2, 1944

SUBJECT: Grading of Roadway at Main Gate

TO: Commanding Officer, Military Prison Camp No. 1
of the Philippine Islands, Cabanatuan, P. I.

1. It is respectfully suggested that the truck roadway at the Main Gate be ditched and graded according to the attached sketch before gravel is spread. As the area is flat and low, water will stand there in the rainy season and the gravel will sink into the mud unless the rain is drained off by shallow ditches.

2. To build the culvert west of the guard house will require five (5) logs twelve (12) feet long and five (5) inches in diameter from the wood-cutting detail.

CURTIS T. BEECHER
Lieutenant-Colonel, U. S. Marine Corps
Commanding

1 Inclosure - Sketch

Approved

40 9/20/02

DECLASSIFIED
Authority *NW883018*

- A- FLUSH LATRINES TWICE DAILY
- B- POLICE LATRINES DAILY
- C- WASH LATRINE BOXES TWICE WEEKLY
- D- SUBMIT EFFLUENT TO LABORATORY TWICE WEEKLY
- E- REPLACE WORNOUT SHUTE IN NON-DYSENTERY LATRINE

II- SANITATION

- A- COLLECT AREA GARBAGE
- B- BURN COMBUSTIBLE WASTE
- C- BURY WET GARBAGE
- D- COLLECT, SMASH, AND DISPOSE OF TIN CANS
- E- CLEAN OUT ALL DRAINAGE DITCHES

III- BEAUTIFICATION

- A- CUT GRASS AND POLICE AREA AROUND CLINIC BLDG
- B- " " " " " " " " SURGICAL WARD
- C- CLEAN GRASS FROM PATHS & DITCHES IN DYSENTERY AREA
- D- POLICE AREA TWICE WEEKLY FOR INSPECTION

IV- GENERAL UTILITIES

- | | |
|--------------------------------------|------------------------------------------------|
| A- REPAIR 11 BUCKETS | O- REPAIR HQ. DOOR |
| B- REMOVE OLD ROOF FROM WOOD SHED | P- REPAIR DOORS WD #12 |
| C- PUT COGON GRASS ROOF ON WOOD SHED | Q- CONSTRUCT DOOR WD #9 |
| D- REPAIR SUPPLY ROOF (COGON GRASS) | R- " " 2 COMMUNION TRAYS |
| E- " HQS. " " " " | S- " " LATRINE SHUTE |
| F- " WD #13 " " " " | T- " " LITTES - COMMISSAR |
| G- " WD #5 " " " " | U- REPAIR " - RATIONS |
| H- MAKE MEDICINE CABINET WD #13 | V- MAKE DUCK BOARD FOR HQS. |
| I- REPAIR CLINIC BLDG. WALK | W- CONSTRUCT RAIN-BREAK FOR DISPENSERY |
| J- MAKE SHOVEL FOR QUAN STOVE | X- CONSTRUCT DESK-DISPENSERY |
| K- REPAIR FENCE | Y- BUILD TABLE & BENCHES FOR WD #7 |
| L- MOVE DYSENTERY FENCE | Z- INSPECTION, ISSUE, AND MAINTENANCE OF TOOLS |
| M- CONSTRUCT SURGICAL BED FRAME | |
| N- REPAIR WINDOWS MESS #1 | |

DECLASSIFIED
Authority: NND 88308

11 4/20

Allison L. Hartman
CAPT. C.E.
HOSP. UTILITIES OFF

April 24, 1944

SUBJECT: Gravel for Road at Main Gate

TO: Commanding Officer, Military Prison Camp No. 1 of the
Philippine Islands, Cabanatuan, P. I.

1. It is requested that 15 cubic meters of gravel be
furnished to surface the truck road between the main gate and the
gravelled area near vegetable shed before the beginning of the
rainy season.

Respectfully,

CURTIS T. BEECHER
Lieutenant-Colonel, U. S. Marine Corps
Commanding.

DECLASSIFIED
Authority NND883018

*Report to
will be handled
Cabanatuan
72 ext per*

Hospital Headquarters,
April 19, 1944.

SUBJECT: Repair of Building in Hospital Area.

TO : The Commanding Officer, Military Prison Camp No. 1 of the Philippine Islands,
Cabanatuan, P. I. (Thru: American Prison Headquarters).

1. Respectfully request permission to brace the floor of Building #10, Hospital Area.
2. Materials required: 50 poles, 5 feet long, 4 to six inches in diameter.

For the Chief of Hospital:

AMERICAN PRISONER HEADQUARTERS

20 April, 1944.

Forwarded, recommending approval.

43 *at*
CURTIS T. BECHER,
Lieutenant Colonel, U. S. Marine Corps,
Commanding.

C. S. Maupin
C. S. MAUPIN,
Major, Medical Corps,
Adjutant.

DECLASSIFIED
Authority: *ND 8830R*

SUBJECT: Request to dig pit for procurement of gravel.

To: The Commanding Officer, Military Prison Camp #1, Cabanatuan, Philippine Islands. (Thru: Commanding Officer, American Prisoner Headquarters.)

1. It is requested that permission be granted to dig a pit approximately 42 feet by ten feet, behind Building No. 1-2, between the guard path and the ditch, in the Group II area.

2. This excavation is desirable for the purpose of procuring gravel to continue work on the repair and maintenance of roads in the Group II area.

Respectfully,

J. G. COOK,
Lt-Col., FA, USA,
Commanding Group II.

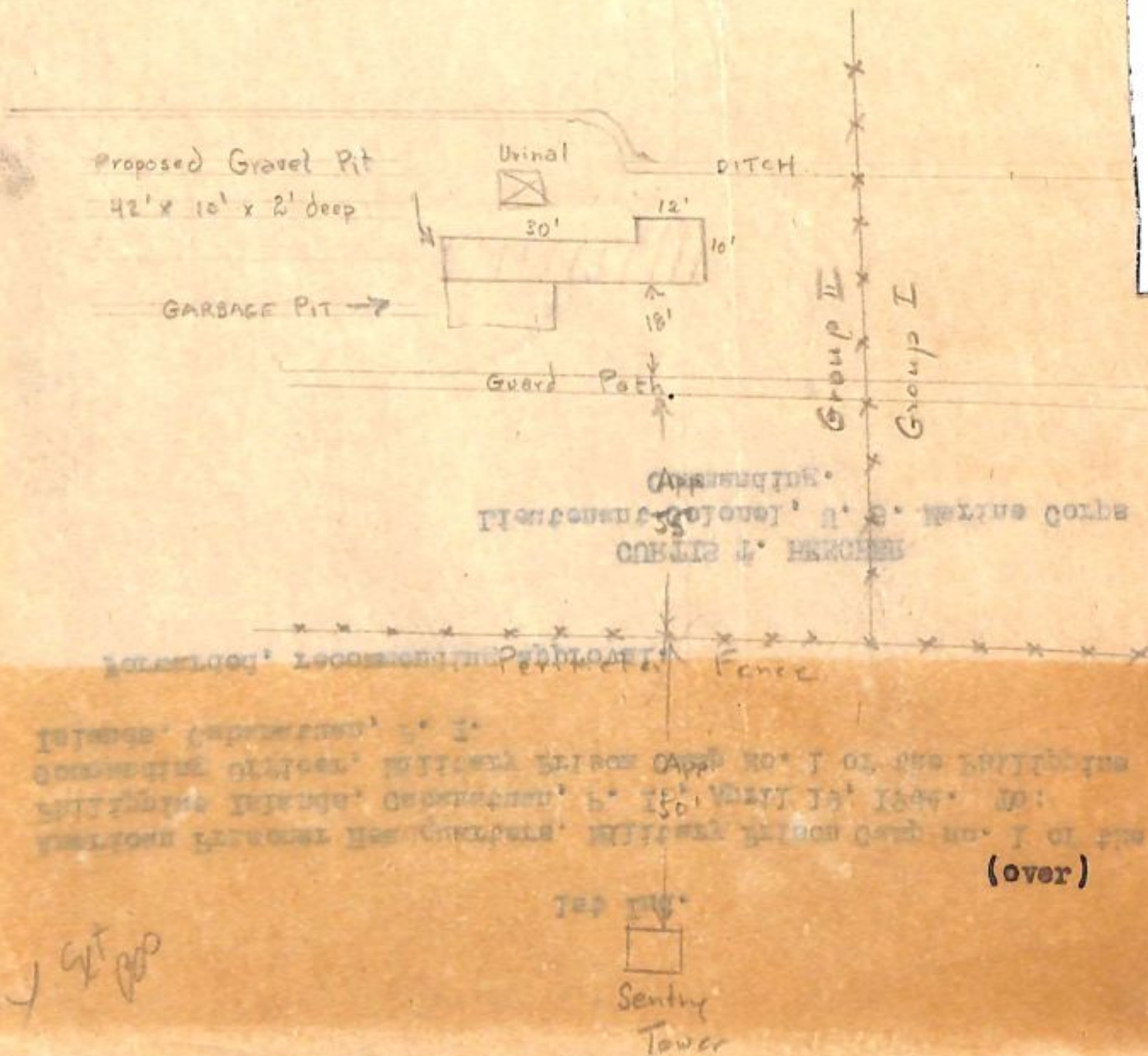

DECLASSIFIED
Authority: *ND 883018*

(over)

44 9/1/50

1st Ind.

(2025)
American Prisoner Headquarters, Military Prison Camp no. 1 of the
Philippine Islands, Cabanatuan, P. I., April 19, 1944. To:
Commanding Officer, Military Prison Camp No. 1 of the Philippine
Islands, Cabanatuan, P. I.

Forwarded, recommending approval.

CURTIS T. BEECHER
Lieutenant-Colonel, U. S. Marine Corps
Commanding.

DECLASSIFIED
Authority ND88308

April 8, 1944

SUBJECT: Shade Lean-To Construction.

To: Commanding Officer, Philippine
Military Prison Camp No. 1, Cabanatuan, P.I.

1. Respectfully request permission to construct a temporary shade shelter at Mess No. 2. This shelter is to provide shade for the woodchoppers in the afternoon. Materials are available in Camp.

2. Diagram of projected shelter. Location:- Woodpile, Mess No. 2.

/s/ LEO C. PAQUET,
Lt. Colonel, Inf.,
Group Commander.

*Approved
4/12/44
Group I notified*

1st Ind

American Prisoner Headquarters, Military Prison
Camp No. 1 of the Philippine Islands, Cabanatuan,
P.I., April 8, 1944. To: Commanding Officer,
Military Prison Camp No. 1 of the Philippine
Islands, Cabanatuan, P.I.

Forwarded, recommending approval.

CURTIS T. BEECHER,
Lieutenant Colonel, U.S. Marine Corps,
Commanding.

DECLASSIFIED
Authority *ND883078*

45-97-100

Cabanatuan, P.I., Headquarters Group I
April 1, 1944

SUBJECT: DOORS IN REAR OF OFFICES

To: Commanding Officer, Philippine Military Prison Camp No. 1,
Cabanatuan, P.I.

Respectfully request permission to put doors on the rear side of the Headquarters Group I, Headquarters, Group II, and Group I Work Details Offices of the American Prisoner Headquarters building by cutting a portion of the wall just below the windows (See attached drawing). Each door will be approximately two feet by two and one-half feet. Materials are available in camp.

For the Group Commander:

G. B. GROSS,
Major, Inf.,
Adjutant.

*Disapproved
Original returned
H/S/44*

1st Ind

American Prisoner Headquarters, Military Prison
Camp No. I of the Philippine Islands, Cabanatuan,
P.I., April 1, 1944. To: Commanding Officer,
Military Prison Camp No. 1 of the Philippine
Islands, Cabanatuan, P.I.

Forwarded, recommending approval.

CURTIS T. BECHER,
Lieutenant Colonel, U.S. Marine Corps
Commanding.

DECLASSIFIED
Authority *NDS88308*

46 4+ 100

December 7, 1943.

SUBJECT: Remodeling of Field Medical Headquarters.

TO: American Headquarters, this camp.

1. Respectfully request that permission be granted to divide the front doors of Field Medical Headquarters (south section of Headquarters building) into two sections.
2. If permission is granted it will greatly improve the lighting condition, which is now a serious problem.
3. This change will not alter the appearance of the building.

Approved

W. R. Craig
W. R. CRAIG,
Lt. Col., M.C.,
Medical Director.

DECLASSIFIED
Authority: NND883078



Building No. 4 FPH

these doors not used

Note: Doors to be divided into sections as indicated by dotted line.

Approval Recommended:

Curtis J. Beecher
47 *atp* Lt. Col. U.S. Marine Corps

Approved
(TBW)

November 30, 1943

Item	Unit	On Hand	Received	Issued	Balance
Soap	Bar	2326	2299	3158	1467
Toilet Paper	Sheet	225,400	33,840	93,805	165,435
Cardigans	Each	224	0	224	0
"G" Strings	Each	273	558	831	0
Towels	Each	0	419	419	0
Tooth Brushes	Each	0	37	37	0
Tooth Powder	Tube	0	909	909	0

W. F. Swanson

W. F. SWANSON,
Major, M. C.
Supply Officer.

DECLASSIFIED
Authority *ND883018*

October 31, 1943

Quartermaster Activities for
the month of October

Item	Unit	on hand	Rec'd	Issued	Bal.
Soap	Bar	834	4769	2277	2326
Toilet Paper	Sheet	2,460	268,000	45,000	225,400
Tooth Brush	ea	0	359	359	0
Tooth Powder	Pkg	0	329	329	0
Bucket Steel	ea	0	2	2	0
" w/E	ea	0	1	1	0
" G.I.	ea	0	1	1	0
Cardigan	ea	0	278	54	224
Blanket	ea	0	5	5	0
"G" String	ea	0	273	0	273

W. F. Swanson

W. F. Swanson

Major, M.C.

Supply Officer

DECLASSIFIED
Authority NND883018

49 9/10/00

Quarter master Activities for the Month
of September 1943

Sept. 30, 1943

item	Unit	On Hand	Rec'd	Issued	Bal
Soap	Bar	750	1134	1050	834
Shirt	ea	6	0	6	0
Pants	prs.	9	0	9	0
Toilet Paper	Sheet	24,400	0	22,000	2,400
Clay Pots & lid	ea	0	7	7	0
Broom	ea	0	8	8	0
Pot, Stock, 20 gal	ea	0	2	2	0
Cans, G.I.	ea	0	1	1	0
Can, Milk	ea	0	1	1	0
Pitcher, Alm.	ea	0	1	1	0
Caldron, Med	ea	0	4	4	0
Caldron, Small	ea	0	1	1	0

DECLASSIFIED
Authority NND883018

H. H. Gard
H. H. Gard
Capt. Mod Adm. C.
Supply Officer.

50 apt pop

11
 A
 Air
 A
 Ho
 No
 K

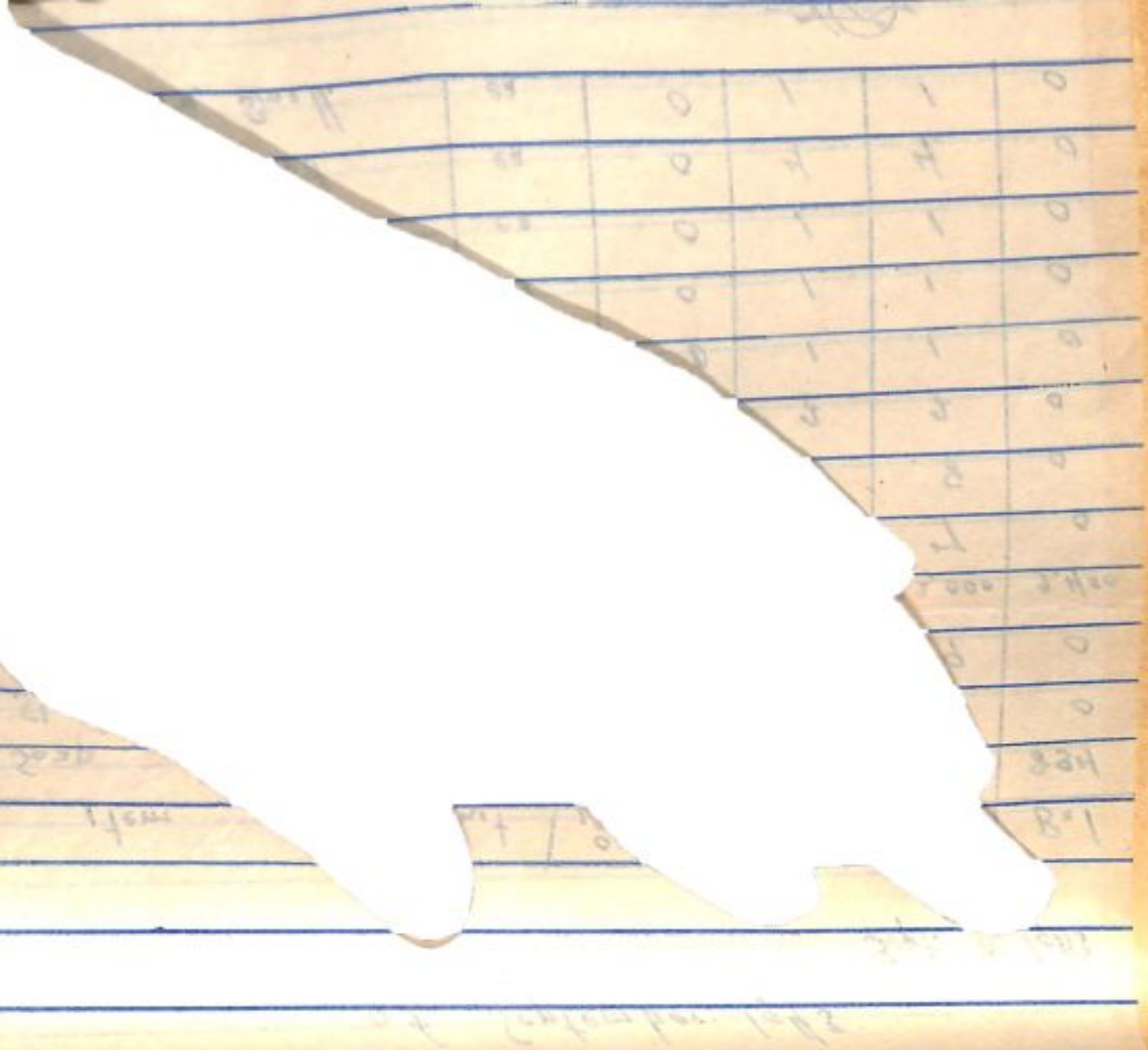

for the month of August, 1945

Aug 31, 1945

Items	Units	on hand	Rec'd	Issued	Bal.
"G" Straps	ea	0	1910	1910	0
Socks	Pcs	90	696	786	0
Soap	Bars	600	900	750	750
Shirts	ea	0	12	6	6
Shorts	Pcs.	0	21	12	9
Tooth Powder	Pkg.	938	0	938	0
toilet Paper	Sheet.	65,400	0	42,000	23,400

H. L. Gard,
 Capt. Med. Hdq. C.
 Supply Officer.

DECLASSIFIED
 Authority: **NND88308**

51 9x100

August 21, 1943.

SUBJECT: Request for electric light.

TO: Dr. Suehiro, Surgeon, Imperial Japanese Army.

1. It is respectfully requested that permission be granted to install an electric light in the Dispensary of Group III. Due to the fact that most men of the Group work during most of the daylight hours, it is necessary to treat some cases at night. There is at the present time no light available for emergencies. Steps will be taken to insure that the light will not be used excessively or for individual purposes. At the present, electric wires are on the dispensary (Building 14) and connection of the electric light will require very few materials.

DECLASSIFIED

Authority NND883018

W. HINTON DRUMMOND,
Lt. Col., M.C.,
Field Surgeon.

July 31, 1943

Memorandum:

1. Listed below is a report of
Quartermaster activities for the month of
July, 1943.

item	on hand	received	issued	balance
Blankets	70	0	70	0
Socks	80	0	10	90
Soap	486	580	466	600
Toilet Paper	0	143,000	77,600	65,400
Tooth Powder	0	938	0	938

DECLASSIFIED
Authority NND883018

W. R. Gard
Capt. Med Adm. C,
Supply Officer

53 9th pp

July 31, 1943.

Memorandum To The Commanding Officer:

1. Submit herewith report of Mess Personnel for the month ending July 31, 1943:

Mess 1:	Med: 21	Serv: 11
2:	Med: 10	Serv: 14
3:	Med: 20	Serv: 10
	<u>51</u>	<u>35</u>

Total: 86

DECLASSIFIED
Authority NND 883018

Officer in Charge of Messes

57 9th pp.

June 3, 1943.

SUBJECT: Moving Buildings.

TO : Dr. Suehiro, Surgeon, Imperial Japanese Army.

1. This communication is submitted as a correction of the Sanitary Report for May, 1943.

2. In paragraph V, page 12 we stated that the buildings placed outside the hospital area by the hospital consolidation were not available for use. That is an error. Authority has been granted to move two buildings into the area.

W. R. CRAIG,
Lt. Col., M.C.,
Medical Director.

55 A+ve

DECLASSIFIED
Authority NND883018

MAY 17, 1943

MEMO TO CAMP UTILITIES OFF.

1. THE FOLLOWING ESTIMATE OF MATERIALS REQUIRED FOR CONSTRUCTION OF LATRINE SHELTERS FOR THE HOSPITAL AREA IS SUBMITTED. ESTIMATE IS BASED ON CONSTRUCTION OF 16 SHELTERS OF THE FOLLOWING TYPE COMPLETE.

2. FOR CONSTRUCTION OF 1 SHELTER:

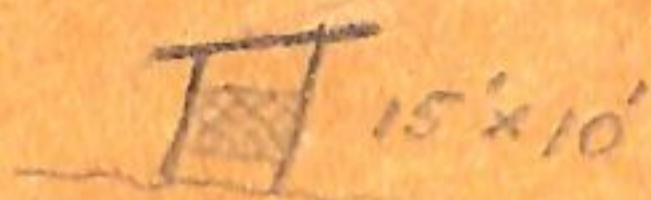

- ROOF - 280 SQ. FT.
- SIDES - 250 SQ. FT.
- POSTS - 50 LINEAR FT. 4" x 4"
- RAFTERS - 200 " " 2" x 4"

DECLASSIFIED
Authority NND88308

TOTAL MATERIALS FOR 16 SHELTERS COMPLETE.

- ROOFING - 4,480 SQ. FT.
- SIDING - 4,000 SQ. FT.
- POSTS - 800 LINEAR FT. 4" x 4"
- RAFTERS - 3,200 " " 2" x 4"

16 x 10

75

A. I. HARTMAN
ASST. UTIL. OFF.

Jan. 26, 1943.

Subject: Lights in the Hospital Area.

To : Medical Director, Japanese Headquarters.

1. I have been informed that lights and wiring in the hospital area are to be removed by the Japanese authorities.

2. It is earnestly and respectfully requested that the wiring in the hospital area not be disturbed for the following reasons:

a. All elective surgery is being performed at night due to the absence of flies during the night hours. The operating room is being used almost every night.

b. Many operations must be done at night because they are of an emergency nature. At least one death resulted from the absence of lights before they were installed in the operating room; this was the case of a traumatic rupture of the spleen which occurred in the evening hours.

c. A source of electric power must be available to operate x-ray and other electrical equipment in order to comply with the Japanese order to conduct laboratory and clinical investigations of the neuritides occurring in patients.

DECLASSIFIED
Authority NND883018

J.W. SCHWARTZ,
Lt.Col., Medical Corps,
Chief of Hospital.

HOSPITAL AREA

December 10, 1942

SUBJECT: Request for clothes line wire.
0 : Commanding Officer, American Prisoner Headquarters.

1. Request 500 feet of wire for the purpose of making clothes lines in the hospital area.

For The Commanding Officer

C. S. Maupin
Major, Medical Corps
Adjutant

DECLASSIFIED
Authority NND883018

58 2790
85

To: The Commanding Officer, Cabanatuan War Prisoners
Concentration Camp.

Subject: Power and Water Supply - Cabanatuan Prison Camp No. 3.

1. A field inspection of the power and water supply was
made on July 15, 1942, and the following are submitted.

POWER

PRIME MOVER

Deutz single cylinder, horizontal oil engine H.P. 28.5 RPM
400 Water cooling.

Condition - Apparently fair condition.

Fuel - Normally S.A.N. 40 diesel oil

Consumption - 35 gals. per day.

Started to use coconut oil July 14.

No trouble as yet. Consumption unknown.

GENERATOR

Century - A.C. - 60 cycle 3Ø 240 volts 45 Amps 18.7KVA
15 KW. 1800 R.P.M. 50° cont. open slant winding.

Exciter - D.C. 125V - 500 Watt. - 1800 RPM.

Condition - Apparently satisfactory.

BOARD

Instruments - Voltmeter - ammeter on A.C. & D.C.
watt hour meter. - Current transformers, switch.
Condition - Very poor - Voltmeter records 228V.
and is the only instrument in operating condition.
No fuses on board. Wiring and leads of very poor
quality. Danger of shorts and fire.

ADDITIONAL LOAD

Line shaft-belt driven - Rice mill, grist mill and
other auxiliary equipment operated intermittently.

TRANSMISSION

Wire - About #9 AWG - Insulated.

Poles - 3" G.I. pipe and miscellaneous.

Condition - Extremely poor - broken insulators

wires down - rubbed bare due to abrasion. Obvious
shorts in system. Main line switch not fused.

LOAD - DEEP WELL PUMP.

Fairbanks - Morse vertical pump.

220 volts 12.5 amps - 5 H.P. 3Ø 60 cycle

1755 RPM. Continuous operation.

Switch - fuses shunted out - about #14 AWG wire
to motor.

LOAD - LIGHTING.

8 - 50/ watt globes - 400 watts in vicinity of
swine farm with no consideration given to balan-
cing the load on the 3 phases.

LOAD - CAMP LIGHTING

Main switch at swine farm with 30 amp fuses
shunted out.

turned on at 1800, off at 0600. Wire to camp in
very poor condition. Wires down in places. In-
sulation off in places.

Two legs loaded by camp lights. - No load on third
leg.

(a) Circuit around west side of camp carries about
20 - 50/ watt globes - Total 1000 watts. To this
circuit is added a circuit which crosses the road
to the Japanese camp, having about 10 - 50 watt
globes - Total 500 Watts - Grand Total 1500 watts.

DECLASSIFIED
Authority ND88308

50 watt globes and 6 - 100 watt globes. Total
10 x 50 = 500 / 6 x 100 = 600 watts.
The third leg has no load at all.

CONCLUSIONS

(1) The system is in extremely poor condition due primarily to negligence in maintenance and operation, and secondarily to lack of material.

(2) At the present time the known load is about as follows:

First leg - 2800 / 1500W / 200W = 4500W.

Second leg - 2800 / 1100W / 200W = 4100W.

Third leg - 2800 / 0 / 200W = 3000W /

Total = 11600VA, or 12KVA

This does not approach the KVA capacity of the machine, but the load due to short circuits is not known, and the unbalanced load is extremely undesirable.

RECOMMENDATIONS

(1) With materials and tools now in possession of Japanese, put crew on system to repair and correct the system. Estimated 20 man days.

(2) By tapping the third leg at the northeast corner of the camp place the 500 watt load in the Nipponese area on that leg, removing it from circuit (a).

(3) Place 4 - 50W lights in each galley adding the galley in Group I to the new circuit in the Nipponese area, and the other two galleys to circuit (b). Resulting loads:

Second leg - 2800 / 1100 / 400 / 200 = 4500W.

First leg - 2800 / 1000 / 200 = 3000W.

Third leg - 2800 / 500 / 200 / 200 = 3700W.

(4) The above changes will not increase the critical load on the generator; they will improve the balance and will permit an expansion of 800 Watts in the Japanese and hospital area, without changing the load on the maximum side.

WATER SYSTEM

WELL - Reported to be 150 feet deep - started with 8" casing. Reported to pump 75 gpm., but this is not accepted as correct.

Pump apparently in good condition, described under power system.

TANK - Concrete - 15' diameter - 12' high, capacity about 12000 gallons. Condition fair. Elevation about 80' above pump, and above camp.

PIPE SYSTEM - 42 discharge from pump - reduced to 3". 2" outlet from tank. Tee to swine farm and to camp, both 2" lines. Numerous small leaks in swine farm system.

CONCLUSIONS:

System is in fair shape, but requires maintenance, with necessary tools and supplies available at all times.

RECOMMENDATIONS:

(1) Establish a permanent maintenance crew with tools and equipment.

DECLASSIFIED
Authority NDS8830R

Respectfully,

NAPOLEON BOUDREAU,
Colonel, GAC.
Commanding.

1. SANITATION —

- A. FLUSH LATRINES TWICE DAILY
- B. WASH LATRINE BOXES DAILY
- C. DISINFECT LATRINES WEEKLY
- D. REPAIR SEAT COVERS
- E. COLLECT, SMASH & DISPOSE OF TIN CANS
- F. BURN DRY TRASH
- G. BURY WET GARBAGE
- H. CLEAN DRAINAGE DITCHES BEYOND FENCE.

2. BEAUTIFICATION —

- A. CUT GRASS & POLICE AROUND HQS.
- B. CUT GRASS AROUND SURGERY & WD #5
- C. LEVEL AREA & BUILD WALK NORTH OF
WD #5.
- D. POLICE EXISTING WALKS & DITCHES
TWICE, WEEKLY.

3. GENERAL UTILITIES —

- A. INSTALL COBAN GRASS ROOF ON SURGERY
INCLUDING:
 1. SPIT BAMBOO AND CUT WIRE
 2. ASSEMBLE 800 SHINGLES 3'x3'x4"
 3. WIRE FRAME TO ROOF
 4. TIE SHINGLES TO FRAME
- B. REPAIR LITTERS.
- C. BUILD MEDICINE CHEST FOR WD #15
- D. REPAIR LATRINE BOXES
- E. ADD NEW BAMBOO BRACING TO ALL OLD
ROOF MATS.

61, 4/20/68

- OVER -

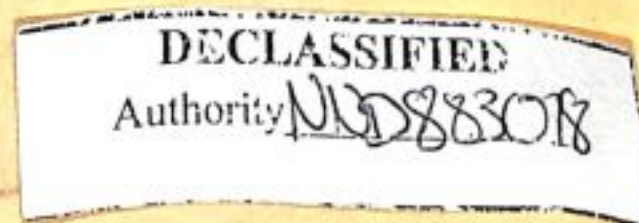

- F. REPAIR HQS. ROOF
- G. PUT WOODEN BOTTOMS IN 10 BUCKETS
- H. ERECT TRELLIS IN FRONT OF HQS.
- I. PUT NEW SEATS IN SENTRY BOXES.
- J. REPAIR CAULDRON COVERS MESS #2
- K. REPAIR WINDOWS MESS #2
- L. REPAIR URINAL WD. #7
- M. MOVE DYSENTERY FENCE
- N. INSTALL ADDITIONAL SHELVING IN LABORATORY.
- O. REPAIR SHOWERS
- P. REPAIR FLOOR IN LABORATORY
- Q. REPAIR GUARD BOXES
- R. REPAIR FENCES
- S. TOOL CHECK & MAINTENANCE.

DECLASSIFIED
 Authority ND88308

Alvin J. Hartman
 CAPT. C.E.
 HOST. UTILITIES OFF.

INTENDED FOR USE
AT THE PORT OF



Application of

LEONCIO VANO ONG DIONG JAY

CUSTOMS FOR INDORSEMENT AS A RESIDENT CHINESE MERCHANT,
ENTITLED TO READMISSION INTO THE PHILIPPINE ISLANDS AFTER TEMPORARY
ABSENCE THEREFROM, IN CONFORMITY WITH SECTION III OF THE
ACT OF CONGRESS OF NOVEMBER 3, 1903

Merchants
Affidavit No. 15472
Filed AUG 19 1915

UNITED STATES OF AMERICA,
PHILIPPINE ISLANDS. } S. S.
City of Manila

LEONCIO VANO ONG DIONG JAY

being first duly sworn on oath deposes and says:

That he is a resident of the City of Cebu,
Cebu P. I., and that he
has resided there for 30 years and has been engaged
for 25 years as merchant
of the legitimate mercantile business located at No 36
Calle Magallanes doing business under
the name and style of

dealing in Sundries, go etc. and paying internal revenue and taxes to
the amount of P..... for the past..... quarters: and that the
has not performed any manual labor during the past year, except such as is necessary in the conduct
of his business as such merchants.

That the partners of said business at this date are as follows, with the share to which they are
entitled, to wit:

NAME	SHARE	DATE OF ENTRY INTO FIRM	CERTIFICATE OF RESIDENCE No.
L. V. Ong Diong Jay,	P 20,000		# 276/762

LANDED AT MANILA, P. I.
(IMMIG. INSP. EXAM.)
TAISANG
Dec. 8/8
DEC 18 1916
Insp.

DECLASSIFIED
Authority ND88308

1. All necessary plumbing and electrical repairs were accomplished during the month. Plumbers were used on numerous jobs outside the compound, the electrician worked four days outside the compound.

2. Sufficient wood was cut for the Japanese and American galleys during the month.

3. The following work was accomplished by the carpenter:

Manufactured:

- Three trash boxes.
- Three rice boxes.
- One gate for pig pen.

Constructed:

- Three wooden gratins
- Two leg cradles
- Three file boxes
- Seven stools
- One bulletin board
- One railing around office
- Two tables
- One drawer for desk.
- One rice paddle

Repairs:

- One shutter for window
- Two chair seats
- Two bunks
- Two clotheslines
- One bracket for roof drain
- One soup can
- Two rice boxes

One straddle trench

Installed:

- Four shelves
- One lock desk drawer

Miscellaneous:

- Strung four strands barbwire
- Carved and set one row marker for cemetery

4. The following items are badly needed for this department:

Saw, crosscut, two man, approximately five feet long

No. 1

File, triangle, 4" x 6"

No. 1

Insert 3

DECLASSIFIED
Authority: NND88308

E. J. Hogan
E. J. HOGAN
Pharmacist, U.S.A.
Military Officer

67

att/pe

DECLASSIFIED

Authority NO 88308

- U- BUILD PIANO LITTER
- V- BUILD TRASH BOX FOR WD #10
- W- BUILD BABBER CHAIR FOR DETACHMENT
- X- REPAIR WINDOWS ON WD #11 & MESS #1
- Y- REMOVE TORN CANVAS FROM MESS #1
- Z- LOWER BAY AND BUILD STORAGE RACK FOR MESS #1
- a- INSTALL BRIDGE WD #17
- b- INSTALL BRIDGE FOR WOODTRUCK
- c- REPAIR TUMP COVERS
- d- DRAIN & LEVEL AREA NORTH OF MESS #1
- e- BUILD LISTER BAG RACK FOR MESS #2
- f- REMOVE BAMBOO BAYS FROM WD #5
- g- REPAIR BAYS IN MESS #1 & WD #6
- h- INSTALL SHELVING IN DISPENSARY

FIELD GUYTON SLINE NO 17

63

- j- BUILD WOODEN SHOES FOR SURGICAL PATIENT
- k- BUILD RICE YAT FOR MESS #1
- l- BUILD SHUTES FOR SEPTIC TANK
- m- DRAW SKETCH OF LATRINES FOR JAPANESE.
- n- REPAIR WINDOWS AND DOORS FOR JAPANESE MEDICAL SUPPLY BUILDING.

Alvan J. Fortman
 Capt. C.E.
 Corp. Utilities off.

DECLASSIFIED
 Authority *NDS88308*

POD

MEMORANDUM

I - LATRINES

- FLUSH ALL LATRINES 4 TIMES DAILY
- WASH LATRINE SEATS DAILY
- LIME LATRINES & SEPTIC TANK WEEKLY

II - SANITATION

- CLEAN OUT DITCHES IN HOSPITAL AREA
- CUT GRASS
- DIG 3 LARGE GARBAGE SUMPS
- BURN DRY TRASH
- COLLECT & SMASH TIN CANS.

III - GENERAL

- A - BUILD NEW PERIMETER GUARD PATH
- B - REPAIR 4 BRIDGES
- C - BUILD SAFTY DOOR AND LOCK ON NP WARD
- D - CONSTRUCT SOLITARY CELL IN NP WARD
- E - INSTALL BARS & INSTALL SOLID FLOORS ON 4 ADDITIONAL BAYS FOR NP WARD.
- F - CONTRUCT AND INSTALL 400 MAN CAPACITY LATRINE AND SEPTIC TANK IN DYSENTERY AREA.
- G - REPAIR FLOOR BLDG #10
- H - REPAIR BAYS BLDGS #1, #3, & #15
- I - REPAIR COVERS AND SHELVES IN MESS #2
- J - " CAULDRON COVERS IN MESS #1
- K - MOVE DYSENTERY FENCE
- L - " HOSPITAL FENCE
- M - REPAIR FENCES
- N - MOVE BLDG TO NEW LOCATION FOR BARBER SHOP

64 7/20/50

OVER

DECLASSIFIED
Authority: NND88308

- O- CLEAN AND DRAIN AREA AROUND AND UNDER CLINIC BLDG.
- P- INSTALL TWO URINALS
- Q- INSTALL 3 CLOTHES LINES
- R- LAY DRAINAGE SYSTEM FROM DYSENTERY SHOWER TO
RAIN SEPTIC TANK OUTLETS.
- S- CONSTRUCT AND INSTALL 500 MAN CAPACITY LATRINE
SEPTIC TANK IN NON-DYSENTERY AREA.
- T- FILL IN OLD SEPTIC TANKS
- U- LEVEL AND LEVEL AREA OUTSIDE GUARD PATH.
- V- DO CHECK AND MAINTENANCE
- W- DRAW SKETCH OF SEPTIC TANK FOR JAPANESE.

A. Hartman
CAPT. C.E.

Hosp. Util. Off.

UTILITIES REPORT

OCTOBER

DECLASSIFIED

Authority: NDS88308

1- LATRINE DETAIL

- A- FLUSH EACH LATRINE FOUR TIMES DAILY
- B- WASH SEATS WITH CRESOL SOLUTION DAILY
- C- LIME BOXES AND SEPTIC TANKS WEEKLY
- D- DAILY SEPTIC TANK AND LATRINE MAINTENANCE
- E- DAILY POLICE OF LATRINE AREAS.
- F- COLLECT WET OR DRY GARBAGE AND DISPOSE OF SAME.

2- BEAUTIFICATION DETAIL (CAPT NASER OR MAJOR WHITE IN CHARGE)

- A- LEVEL, SOO AND PLANT FLOWERS IN FRONT OF HOSP. HQRS.
- B- BUILD PATHS IN NON-DYSENTERY AREA.
- C- SUPERVISE PLANT GROWING IN HOSP. AREA.

3- SANITATION DETAIL

- A- BUILD PATH TO #3 LATRINE
- B- BUILD PATH EAST OF BLDG #9
- C- AID PLUMBERS INSTALL NEW PIPING LAYOUT
- D- CARRY IN 3 LAT. SHEDS AND 2 LAT. BOXES FROM OLD AREA.
- E- MOVE #2 DELOUSER TO APPROVED SITE.
- F- MOVE GUARD BLDG TO APPROVED SITE.
- G- INSTALL WASH RACKS UNDER SPIGGOTS AND SHOWERS
- H- BUILD CHAPEL #2 INCLUDING ALTAR, BENCHES AND KNEE
- I- CLEAN OUT BLDG #7

DECLASSIFIED
Authority: NND88308

- J- COMPLETE 24 HOLE LATRINE, SEPTIC TANK, AND SHED.
- K- INSTALL SHOWER WATER DRAINAGE DITCH TO LATRINE LINE.
- L- ERECT THREE STRAND DYSENTERY FENCE
- M- GRADE, LEVEL, AND TAMP NEW VOLLEY BALL COURT

4- UTILITIES DETAIL

- A- BUILD FILING BOX FOR HQRS.
- B- " TABLE FOR WD #21
- C- REPAIR ROOFS #1, #2, #4, #5, #9, #11, #12, #14, #17, #23, #24, #25
- D- INSTALL PARTITION IN #12 FOR DENT & DENTAL CLINIC
- E- INSTALL WINDOW, SHELVING, & CABINET FOR DENTAL CLINIC
- F- PUT UP 14 CLOTHES LINES
- G- INSTALL BOTTOMS IN 9 BUCKETS
- H- INSTALL SAWALL PARTITION IN #11 FOR SURGICAL DRESSING ROOM
- I- REPAIR DESK FOR DENTAL CLINIC.
- J- INSTALL PARTITION FOR WARD #12 DRESSING ROOM.
- K- BUILD MOVABLE SAWALL PARTITIONS FOR SEGREGATION OF TB PATIENTS.
- L- INSTALL FLOOR IN SUPPLY BLDG.
- M- MOVED WALL TO INCLUDE PORCH, EXTERIOR PARTITIONS, GUT DOORS IN EAST WALL, ERECTED SHELVING, ERECTED SURGICAL LINE, INSTALLED WOODEN WALL AND AND REMOVED RAMPS AT BLDG
- N- MAKE 3 KAWALI COVERS FOR
- O- REPAIR WINDOWS, TABLE, CAULK COVERS, AND BAYS FOR MESS
- P- BUILD BRIDGE FOR HQRS.
- Q- INSTALL SINK AT E.E.N.T.
- R- BUILD VOLLEY BALL STAND
- S- INSTALL TABLE AND MEDIC CABINET FOR WD. #5.
- T- ENLARGE N.P. WARD & INST BRACING, AND INSIDE LATRINE

Allison L. Hartman
Asst. Util. Mgr.

DECLASSIFIED
Authority: NND 883018

- U- CONSTRUCT DUCKBOARD FOR #2; DELOUCER
- V- INSTALL SPIGGOT IN DYSENTERY AREA (BTWN #11 - #13)
- W- BUILD WATERTIGHT BOX FOR SURGERY
- X- BLOCK UP & REPAIR BRACING ON BLDG #23
- Y- INSTALL DOOR IN SUBSISTENCE BLDG. FOR QUAN STOVE
- Z- IMPROVISE CANVAS BACK-BRACE FOR SURGERY
- Q- BUILD 2 TABLES FOR WD #2
- b- REPAIR CAULDRON COVERS FOR MESS #2
- C- MAKE BROOMS FOR MESSSES
- d- PUT HANDLES ON MOPS;
- L- REPAIR MESS #2 RICE YAT.
- f- FIRE PROOF MESS #2 QUAN SHACK
- g- BUILD TWO TABLES WD #27
- h- RAISE AND BLOCK BLDG #12
- i- INSTALL DOOR IN DENTAL CLINIC
- j- ENLARGE MAIN ENTRANCE GATE AND INSTALL BRIDGE
- k- TOOL CHECK AND MAINTENANCE
- l- REPAIR BIRD CAGE FOR JAPANESE
- m- BUILD TWO RULERS FOR JAPANESE

69

SHARPEN BOLDS AND SUPERVISE GRASSCUTTING.

A. L. Hartman
Capt. C. E.
Hosp. Unit's off.

DECLASSIFIED
Authority: NND883078

JULY 1943

1- LATRINES.

- A- LATRINES COMPLETED:
ND. #10, #16, #10, #13, #2, #11, #14, #1, #2, #6, #7, #1, #3, #4, #5
- B- MOVE BOXES AND SHELTERS OVER NEW LATRINES
- C- DRAINAGE DITCHES DUG AROUND LATRINES TO LOWER WATER LEVEL
- D- FILL HOLES ABANDONED & GENERAL MAINTENANCE.

2- BEAUTIFICATION

- A- CUT GRASS IN ENTIRE HOSP. AREA, AND IN MEDICAL DETACHMENT AREA.
- B- CUT GRASS AND CLEAR DEBRIS FROM DITCHES ALONG MAIN PATHS AND ROAD.
- C- FILL HOLES AND LEVEL AREA AROUND WD #12 AND #13
- D- GRAVEL MAIN WALK TO SERIOUSLY ILL SECTION.
- E- DIG DRAINAGE DITCH AROUND DETACHMENT AREA.
- G- GRAVEL MAIN HOSP. PATH AND MAIN GATE ENTRANCE
- H- CLEAN AND ENLARGE WEST DITCH OF MAIN ROAD.

3- GENERAL UTILITIES

- A- MOVE 3 WARD BUILDINGS TO SERIOUSLY ILL SECTION
 - 1- DIG OUT BLDG. 2- SECTION AND REMOVE GATS, 3- BRACE BLDG. FOR MOVING; 4- LEVEL AND PREPARE NEW SITE FOR BLDG.; 5- MOVE BLDG.; 6- REMOVE EXCESS BRACING, SQUARE UP FRAME AND REASSEMBLE BLDG.
- B- REBUILD TWO MAIN GUARD BLDGS.
- C- " FIVE PERIMETER GUARD SHACKS.
- D- " THREE HOSPITAL " "
- E- INSTALL AND/OR REPAIR MATTING ON BUILDING ROOFS #1, #2, #3, #4, #5, #7, #8, #10, #11, #12, #13, #15, #16, #17, #18, #19, #20, #23, #24, #25, #27, #45, #47, #50, MESS #1, DELOUSER #1, 6 LATRINE SHEDS.
- F- ALL BLDGS. RENUMBERED.
- G- CUT OUT AND ISSUE TO DUTY OR PATIENT PERSONNEL 60 PR. SKIVVIES.
- H- REMOVE BLDG. BRACES FOR INSTALLATION OF MOSQUITO NETS.
- G- BUILD TWO DETACHMENT LATRINE SHELTERS.
- I- BUILD TEST TUBE RACK
- J- CLOSE OLD MAIN GATE
- H- REPAIR 3 CANNULONS FOR MESS #3
- I- REARRANGE MESS #1 TO INCREASE FEEDING FACILITIES
- J- BUILD SURGICAL BED FOR WD #1.
- K- INSTALL FAUCET AND SINK IN NEW DENTAL CLINIC

DECLASSIFIED
Authority: NND 88308

67

(OVER)

- L- BUILD TWO SUMP COVERS
- M- BUILD AND INSTALL FOUR WOSP. PATH BRIDGES
- N- CONSTRUCT TRUCK BRIDGE FOR WOOD TRUCKS.
- O- BUILD BRIDGE AND FIX DOOR OF JAPANESE MED. SUPPLY BLDG.
- P- PREPARE 20 BOXES FOR JAPANESE TO HAUL MEDICAL SUPPLIES
- Q- BUILD TABLE FOR BARRY #37
- R- IMPROVISE WRIST BRACE FOR SURGICAL PATIENT.
- S- MOVE DYSENTERY FENCE TO LOCATION SOUTH OF STAGE
- T- REPAIR MESS #1 QUAN SHACK.
- U- INSTALL TWO DOORS ON SUBSISTENCE BLDG.
- V- HELP WORKS BARRACKS IN MOVING TO NEW BLDG. #22
- W- INSTALL MEDICINE SHELVES IN WDS. #15, #18, #19
- X- INSTALL WINDOWS ON BLDG. #18, #19.
- Y- BUILD CLOTHES LINE FOR WD. #13.

A. L. Hartman
 Capt. C. E.
 Hosp. Utility Office

DECLASSIFIED
 Authority NND883018

UTILITIES WORK REPORT

- MAY 1943 -

64

A- LATRINES

- 1- LATRINES COMPLETED:
15A, "B" OFF. LAT., 10B, 8B, 13B, ~~DETACHMENT 1A~~ A, DET. LAT. B.
- 2- MAINTENANCE OF CURRENT LATRINES.
- 3- FILLING AND POLICE OF OLD LATRINES.

B- BEAUTIFICATION

- 1- WEST GUARD PATH IMPROVED
- 2- SHALLOW URINAL & DRAINAGE DITCH DUG ALONG LATRINE LINE
- 3- CLEAN DITCHES ALONG MAIN ROAD
- 4- IMPROVE AND/OR GRAVEL PATHS:
WD#1, WD#11, WD#14, WD#13, PATH TO MAIN CAMP CLINIC, WD#16, WD#2, WD#5
- 5- CONSTRUCT & GRAVEL MAIN N-S PATH THRU MIDDLE HOSP. AREA.
- 6- INSTALL DITCHES IN VICINITY OF:
WD#1, MESS#5, SO. OF VERY SICK AREA, WD#8, WD#9, WD#13, WD#16, WD#17

C- GENERAL UTILITIES

- 1- REPAIR ROOFS ON BLDGS:
#27, #11, #31, #36, #4, #5, #35, #26, #23, #20, #21, MESS#3, CLINIC, #28,
- 2- INSTALL WINDOWS BLDGS:
MESS#3, #30, #24, #42, #49, #50,
- 3- REPAIR FLOOR AND/OR BAYS BLDGS:
#25, #15, #9, #14, #23
- 4- START JAPANESE AUTHORIZED URINAL
- 5- REPAIR CLOTHES LINES
- 6- BUILD & FLY TRAPS
- 7- " 5 STABLES & 2 STOOLS
- 8- " 5 FALSE BOTTOMS FOR DELOUSERS
- 9- SALVAGE MESS#4
- 10- PREPARE BLDGS. #30 & #31 FOR MOVING TO NEW SITE.
- 11- CONSTRUCT DOOR MESS#2
- 12- PAINT WD#1
- 13- BUILD & INSTALL 9 PATH BRIDGES
- 14- MOVE & ALTER MESS#2 QUAN SHACK
- 15- MOVE MESS#3 QUAN SHACK
- 16- CHECK & MAINTENANCE

DECLASSIFIED
Authority: NND88308

A. J. Hartman
CAPT. C. E.
HEAD UTILITIES OFF.

4794

...
army sgt Goldsmith, Leonard
Dish

DECLASSIFIED
Authority: NND883078

UTILITIES REPORT
FOR THE MONTH OF JUNE, 1943.

W

1. LATRINES.

A. LATRINES COMPLETED -
#11, #12, #14B, #15B, #18, #10B, WD #1LAT, WD #2LAT, #14C, #1B, #11C,
#16A, #8C, 2 DETACHMENT LAT., #9C, #6B, #14D, #12D.

B. LATRINE MAINTENANCE

- 1- MOVING BOXES
- 2- POLICING LATRINE AREA
- 3- DITCHING LATRINE AREA FOR LATRINE & URINAL DRAINAGE
- 4- RECLAIM BOXES FROM ABANDONED SOUTH AREA.
- 5- INSTALL 10 LATRINE PIPE DRAINS.

2. BEAUTIFICATION.

- A- GRASS CUTTING OF HOSP. AREA.
- B- DRAINAGE DITCHES - WEST GUARD PATH, MESS #2, MAIN ROAD,
MAIN HOSP PATH, AND EXTEND DRAIN FROM LOW AREA OUTSIDE FENCE.
- C- NEW WALKS - MAIN 10' WALK CONSTRUCTED FROM SOUTH END
MESS #3 TO WOOD SHED, VIC MESS #2 & #15, #43 - #45, NORTH
OF DET. AREA TO MAIN CAMP, SOUTH #20 - #22.
- D- GRAVELING WALKS - MAIN WALK TO CAMP HQS., VIC. #20 - #22, NEW
MAIN WALK VIC #24, VIC #29 - #30, VIC #42 - #49,
E- IMPROVE GUARD PATH.

3. GENERAL UTILITIES

- A- MOVE BLDG TO LOCATION AS #20 (NEW)
- B- PREPARE #29 & #30 FOR OCCUPANCY AFTER MOVING.
- C- SALVAGE MESS #4
- D- CONSTRUCT 10 14'x14' LATRINE SHEDS.
- E- " MESS #2 QUAN SHACK
- F- PLACE DOORS ON #50
- G- CONSTRUCT FRACTURE BED FOR SURGERY
- H- INSTALL DOORS ON #31
- I- CONSTRUCT CABINET - MESS #5
- J- CONSTRUCT PULLEY SYSTEM FOR SURGERY
- K- REPAIR WINDOWS WD #5
- L- " BAYS WD #12
- M- CONSTRUCT 2 BACK RESTS FOR WD #8
- N- REPAIR DOOR WD #1
- O- PREPARE 3 VACANT BARRACKS FOR MOVING
- P- INSTALL 5 FOOT BRIDGES
- Q- REPAIR ROOFS - WD #2, WD #3, #45 AND #49, CLINIC BLDG,
SECTION BAYS FOR DELOUSING #24, OLD #27, 25 & #39.
REPAIR MESS #5 QUAN SHACK
STRAIGHTEN & BRACE WOOD SHED

DECLASSIFIED
Authority: NND 883018

A.L. Hartman